

## **Riveters & Riveting**

- Riveting Hammers .....194
- Rivet Sets .....198
- Tungsten Bucking Bars ..... 204
- Steel Bucking Bars..... 206
- Desoutter Rivet Squeezers ..... 208
- Other Rivet Squeezers ..... 210
- Manual Rivet Squeezers .....212
- Gage Bilt Riveters ..... 214
- Gage Bilt Power Tools ..... 217
- Hi-Lok® Tooling .....221
- Hi-Lok® Box Ratchets .....224
- Hi-Lok® Roller Ratchets..... 226
- Hand Tools .....234
- Temporary Fasteners..... 236
- WCI Cold Expansion Technology .....240



# Riveting Hammers

## DESOUTTER RIVETING HAMMERS

For applications requiring the special "Alligator Jaws or C-Yokes"



Part No.	Model	Air Ref	Frame Ref	Blow per Minute	Bore & Stroke	Energy per Blow		Chisel Shank	Rivet Capacity		Weight		Air Inlet		Hose Int. Ø	
						J	ft.lb		mm	in.	mm (in)	mm (in)	kg	lb		in
<b>Standard</b>																
T022961	CP4444-RURAB	A	2X (200)	2580	12.7 x 50.8 (1/2 x 2)	4.0	2.9	10.2	0.401	3.2 (1/8)	2.4 (3/32)	1.0	2.2	1/4	10	3/8
T022962	CP4444-RUSAB	A	3X (300)	2160	12.7 x 76.2 (1/2 x 3)	6.1	4.5	10.2	0.401	4.8 (3/16)	4.0 (5/32)	1.1	2.3	1/4	10	3/8
T022963	CP4444-RUTAB	A	4X (240)	1740	12.7 x 101.6 (1/2 x 4)	8.1	6.0	10.2	0.401	6.4 (1/4)	4.8 (3/16)	1.3	2.7	1/4	10	3/8
T022965	CP4447-RUSAB	B	5XB (500)	1560	19.1 x 68.3 (3/4 x 2-11/16)	12.3	9.1	12.7	0.498	6.4 (1/4)	4.8 (3/16)	2.2	4.7	1/4	10	3/8
T022912	CP4447-RUTAB	B	7XB (700)	1140	19.1 x 98.4 (3/4 x 3-7/8)	17.8	13.1	12.7	0.498	7.9 (5/16)	6.4 (1/4)	2.3	5.1	1/4	10	3/8
T022964	CP4447-RUVAB	B	9XB (800)	900	19.1 x 147.6 (3/4 x 5-13/16)	26.6	19.6	12.7	0.498	9.5 (3/8)	7.9 (5/16)	2.7	9.0	1/4	10	3/8
<b>Vibration reduced</b>																
T025189	CP4450-2	C	2X (200)	2580	12.7 x 50.8 (1/2 x 2)	4.0	2.9	10.2	0.401	3.2 (1/8)	2.4 (3/32)	1.2	2.7	1/4	10	3/8
T025190	CP4450-3	C	3X (300)	2160	12.7 x 76.2 (1/2 x 3)	6.1	4.5	10.2	0.401	4.8 (3/16)	4.0 (5/32)	1.3	2.8	1/4	10	3/8
T025191	CP4450-4	C	4X (400)	1740	12.7 x 101.6 (1/2 x 4)	8.1	6.0	10.2	0.401	6.4 (1/4)	4.8 (3/16)	1.5	3.2	1/4	10	3/8
T025241	CP4475-3	D	5XB (500)	2000	19.1 x 76.2 (3/4 x 3)	13.7	10.1	12.7	0.498	6.4 (1/4)	4.8 (3/16)	1.8	3.9	1/4	10	3/8
T025242	CP4475-4	D	7XB (700)	1700	19.1 x 101.6 (3/4 x 4)	18.3	13.5	12.7	0.498	7.9 (5/16)	6.4 (1/4)	2.4	5.3	1/4	10	3/8
T025243	CP4475-6	D	9XB (800)	1250	19.1 x 152.4 (3/4 x 6)	27.5	20.3	12.7	0.498	9.5 (3/8)	7.9 (5/16)	2.8	6.2	1/4	10	3/8
2051467124	CP4450-S-2	E	2X	2580	12.7 x 50.8 (1/2 x 2)	4.0	2.9	10.2	0.401	3.2 (1/8)	2.4 (3/32)	1.25	2.8	1/4	10	3/8
2051467134	CP4450-S-3	E	3X	2160	12.7 x 76.2 (1/2 x 3)	6.1	4.5	10.2	0.401	4.8 (3/16)	4.0 (5/32)	1.35	3.0	1/4	10	3/8
2051467144	CP4450-S-4	E	4X	1740	12.7 x 101.6 (1/2 x 4)	8.1	6.0	10.2	0.401	6.4 (1/4)	4.8 (3/16)	1.45	3.2	1/4	10	3/8

\* light: Aluminium 2017 / 2117 (DCJ-DXJ / D-AD)  
 \*\* hard: Aluminium 7050 (DKJ / KE / E) (M) (T)

Model	A	
	mm	in.
CP4444-1	111	4.4
CP4444-RURAB	170	6.7
CP4444-RUSAB	186	7.3
CP4444-RUTAB	211	8.3
CP4447-RUSAB	227	8.9
CP4447-RUTAB	252	9.9
CP4447-RUVAB	303	11.9

Model	A		B		C		D	
	mm	in.	mm	in.	mm	in.	mm	in.
CP4450-2	213	8.4	32	1.26	102	4.0	138	5.4
CP4450-3	226	8.9	32	1.26	102	4.0	138	5.4
CP4450-4	251	9.9	60	2.36	102	4.0	138	5.4
CP4475-3	275	10.8	54	2.13	180	7.1	140	5.5
CP4475-4	300	11.8	79	3.11	180	7.1	140	5.5
CP4475-6	351	13.8	130	5.12	180	7.1	140	5.5

## DESOUTTER STRAIGHT RIVET GUNS

- Desoutter in-line rivet gun with vibration reduced dampner fitted.
- Ideal for over structure applications



Part No.	Blows/Min	Capacity	Shank	OAL	Ref
CP4450-S-2	2,580	1/8" (al) - 3/32" (st)	.401	220mm	2x
CP4450-S-3	2,160	3/16" (al) - 5/32" (st)	.401	223mm	3x
CP4450-S-4	1,740	1/4" (al) - 3/16" (st)	.401	258mm	4x

## HENCHMAN RIVET GUN

- Lower cost rivet guns with power and control to uniformly drive solid rivets
- With incorporated teasing trigger, allowing you to slowly begin riveting without damaging the skin.
- Fitted with a universal retaining spring



Part No.	Blows/Min	Capacity	Stroke	Weight	OAL
H-2X	2580	1/8"	2 1/4"	3.1 lbs	6 11/16"
H-3X	2160	3/16"	2 7/8"	3.2 lbs	7 5/16"
H-4X	1740	1/4"	3 1/16"	3.4 lbs	8 1/2"

## "JIFFY STYLE" RIVET GUN

- Jiffy type rivet gun for close work in confined spaces
- Special short shank rivet sets for jiffy rivet guns, see our selection
- Sensitive teasing trigger
- Will handle some 3/16" rivets in shorter length



Part No.	Blows/Min	Capacity	Shank	Weight	OAL
T-1X	2,850	5/32" Rivet	.401	0.5kg	100mm

## HENCHMAN STRAIGHT RIVET GUNS

- Ideal for areas which would be inaccessible with pistol shaped rivet guns
- Combined with the 90o attachment shown below, you can access extremely awkward spots



Part No.	Blows/Min	Capacity	Shank	OAL	Ref
H-3X-S	2100	3/16" Rivets	.401	220mm	3x
H-4X-S	1700	1/4" Rivets	.498	223mm	4x

## TAYLOR RIVET GUNS

- Lower cost rivet guns with power and control to uniformly drive solid rivets
- Excellent teasing triggers for precise control
- Fitted with beehive style retaining springs



Part No.	Blows/Min	Capacity	Shank	Weight	OAL
T-2X	2600	1/8"	.401	1.0kg	170mm
T-3X	2100	3/16"	.401	1.1kg	186mm
T-4X	1700	1/4"	.401	1.3kg	211mm
T-5X	1800	1/4"	.498	2.2kg	227mm
T-7X	900	3/8"	.498	2.7kg	303mm
T-9X	1150	3/8"	.498	2.3kg	252mm

## HENCHMAN RIVET GUN RETAINER SPRINGS



Part No.	Description	Diameter	Ref
RG1001	Beehive retainer spring	1-3/32"	2x, 3x, 4x
RG1002	Beehive retainer spring	1-3/16"	5x, 7x, 9x
RG1003	Beehive retainer spring	1-5/32"	Jiffy model
RG1004	Handi retainer spring	1-3/32"	2x, 3x, 4x
RG1005	Handi retainer spring	1-3/16"	5x, 7x, 9x
RG1006	Quick Change spring	1-3/32"	2x, 3x, 4x
RG1007	Quick Change spring	1-3/16"	5x, 7x, 9x
RG1008	Quick Change spring	1-5/32"	Jiffy model
RG1009	Universal Retainer Spring	1-3/32"	2x - 7x

## 90° RIVET GUN ATTACHMENT

- An extremely versatile attachment fitting both CP and Taylor rivet guns
- Accepts all .401" rivet sets including the Jiffy type



Part No.	Description
RG 1151	90° Rivet Gun Attachment

## RIVET GUN SHAFT REDUCER

- From Shank .401 to .498
- Hardened steel
- Open at both ends to allow maximum riveting power
- Increases the versatility of o.498 bore rivet gun



Part No.	Description
RS4013	Rivet Gun Shaft Reducer

## ANTIVIBRATION RIVETERS GLOVES

- A-Grade leather
- Gel padded palm and wrist support.
- Fingerless gloves"
- Flexible neoprene breathable back
- Reinforced thumb crutch
- Velcro strap fastener
- Manufactured to EN388 Level 2343 std



Part No.	Description	Size
GMG294-M	Anti Vibration Riveters Glove	Medium
GMG294-L	Anti Vibration Riveters Glove	Large
GMG294-XL	Anti Vibration Riveters Glove	X Large

## EARMUFFS 26DB CLASS 5 BLUE

- Unique Elastex sweat reducing ear cushions
- Super low headband tension for extended use
- Replaceable cushioned headband
- Two-point suspension for simple height adjustment
- Non crack, non shrink, no PVC material
- Made in Germany



Part No.	Description
H540A	90° Rivet Gun Attachment

## RIVET GUN KIT

- 3 x Rivet Gun (with a very sensitive teasing trigger and powder coat finish)
- Retaining Spring and Beehive Retaining Spring
- 4 each Cupped Rivet Sets, 3-1/2" Straight, .401 Shank (3/32", 1/8", 5/32", & 3/16")
- Flush Rivet Set with 1" Face (highly polished - excellent quality!)
- 2oz bottle of Air Tool Oil
- Fitted Storage Case
- Roll of Teflon Tape
- Brass Air Regulator
- Air Tool Fitting
- Fitted Storage Case



Part No.	Description
RGK3X	Rivet Gun Kit

## RIVET GUN KIT WITH 2 BUCKING BARS

- 3 x Rivet Gun (with a very sensitive teasing trigger and powder coat finish)
- Retaining Spring and Beehive Retaining Spring
- 4 each Cupped Rivet Sets, 3-1/2" Straight, .401 Shank (3/32", 1/8", 5/32", & 3/16")
- Flush Rivet Set with 1" Face (highly polished - excellent quality!)
- 2 x Bucking Bars (BB1029 and BB1080)
- 2oz bottle of Air Tool Oil
- Roll of Teflon Tape
- Brass Air Regulator
- Air Tool Fitting
- Fitted Storage Case



Part No.	Description
RGK3X-1	Rivet Gun Kit

## RIVET GUN KIT WITH 4 BUCKING BARS

- 3 x Rivet Gun (with a very sensitive teasing trigger and powder coat finish)
- Retaining Spring and Beehive Retaining Spring
- 4 each Cupped Rivet Sets, 3-1/2" Straight, .401 Shank (3/32", 1/8", 5/32", & 3/16")
- Flush Rivet Set with 1" Face (highly polished - excellent quality!)
- 4 x Bucking Bars (BB1029, BB1080, BB1082 and BB1147)
- 2oz bottle of Air Tool Oil
- Roll of Teflon Tape
- Brass Air Regulator
- Air Tool Fitting
- Fitted Storage Case



Part No.	Description
RGK3X-2	Rivet Gun Kit



# Rivet Sets

## RIVET TYPE CHART

Note: Generally all Rivet sets offered below suit AN470 Universal Rivets unless otherwise specified

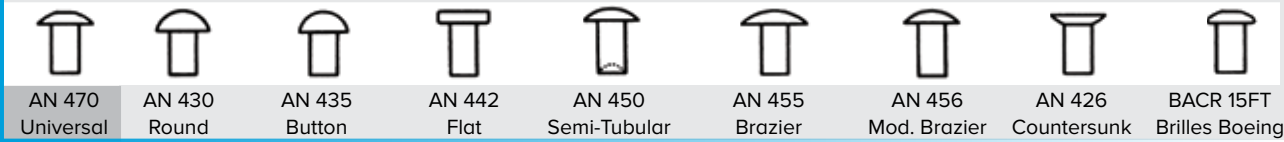

## RIVET SETS – UNIVERSAL



Part No.	Rivet Size	Shank Size	OAL (in/mm)
RS4102-4703	3/32"	.401	2-1/2 / 64
RS4102-4704	1/8"	.401	2-1/2 / 64
RS4102-4705	5/32"	.401	2-1/2 / 64
RS4102-4706	3/16"	.401	2-1/2 / 64
RS4102-4708	1/4"	.401	2-1/2 / 64
RS4302-4703	3/32"	.401	3-1/2 / 90
RS4302-4704	1/8"	.401	3-1/2 / 90
RS4302-4705	5/32"	.401	3-1/2 / 90
RS4302-4706	3/16"	.401	3-1/2 / 90
RS4302-4708	1/4"	.401	3-1/2 / 90
RS4402-4703	3/32"	.401	5-1/2 / 140
RS4402-4704	1/8"	.401	5-1/2 / 140
RS4402-4705	5/32"	.401	5-1/2 / 140
RS4402-4706	3/16"	.401	5-1/2 / 140
RS4402-4708	1/4"	.401	5-1/2 / 140
RS4502-4703	3/32"	.401	7-1/2 / 190
RS4502-4704	1/8"	.401	7-1/2 / 190
RS4502-4705	5/32"	.401	7-1/2 / 190
RS4502-4706	3/16"	.401	7-1/2 / 190
RS4502-4708	1/4"	.401	7-1/2 / 190
RS4602-4703	3/32"	.401	- / 267
RS4602-4704	1/8"	.401	- / 267
RS4602-4705	5/32"	.401	- / 267
RS4602-4706	3/16"	.401	- / 267
RS4702-4703	3/32"	.401	- / 343
RS4702-4704	1/8"	.401	- / 343
RS4702-4705	5/32"	.401	- / 343
RS4702-4706	3/16"	.401	- / 343

## UNIVERSAL MUSHROOM RIVET SET 3-1/2" SERIES



Part No.	Description
RS4302-4305	Set 8 Pcs: Straight (3/32, 1/8, 5/32, 3/16) Offset (3/32, 1/8, 5/32, 3/16)

## RIVET SETS – 10° OFFSET



Part No.	Rivet Size	Shank Size	OAL (in/mm)
RS4305-4703	3/32"	.401	3-1/2 / 90
RS4305-4704	1/8"	.401	3-1/2 / 90
RS4305-4705	5/32"	.401	3-1/2 / 90
RS4305-4706	3/16"	.401	3-1/2 / 90
RS4305-4708	1/4"	.401	3-1/2 / 90
RS4405-4703	3/32"	.401	5-1/2 / 140
RS4405-4704	1/8"	.401	5-1/2 / 140
RS4405-4705	5/32"	.401	5-1/2 / 140
RS4405-4706	3/16"	.401	5-1/2 / 140
RS4405-4708	1/4"	.401	5-1/2 / 140
RS4505-4703	3/32"	.401	7-1/2 / 190
RS4505-4704	1/8"	.401	7-1/2 / 190
RS4505-4705	5/32"	.401	7-1/2 / 190
RS4505-4706	3/16"	.401	7-1/2 / 190
RS4505-4708	1/4"	.401	7-1/2 / 190
RS4605-4703	3/32"	.401	- / 267
RS4605-4704	1/8"	.401	- / 267
RS4605-4705	5/32"	.401	- / 267
RS4605-4706	3/16"	.401	- / 267
RS4705-4703	3/32"	.401	- / 343
RS4705-4704	1/8"	.401	- / 343
RS4705-4705	5/32"	.401	- / 343
RS4705-4706	3/16"	.401	- / 343

## RIVET SETS – GOOSENECK



Part No.	Rivet Size	Shank Size	OAL (in/mm)
RS4503-4703	3/32"	.401	7-1/2 / 190
RS4503-4704	1/8"	.401	7-1/2 / 190
RS4503-4705	5/32"	.401	7-1/2 / 190
RS4503-4706	3/16"	.401	7-1/2 / 190
RS4503-4700	Set 4 Pcs (3/32, 1/8, 5/32, 3/16)		

## RIVET SETS – DOUBLE OFFSET



Part No.	Rivet Size	Shank Size	OAL (in/mm)
RS4406-4703	3/32"	.401	5-1/2 / 140
RS4406-4704	1/8"	.401	5-1/2 / 140
RS4406-4705	5/32"	.401	5-1/2 / 140
RS4406-4706	3/16"	.401	5-1/2 / 140

## FLUSH MUSHROOM RIVET SET – SHORT SERIES



Part No.	Dia (in/mm)	Shank Size	OAL (mm)
RS4004-4719	3/4 / 19	.401	48
RS4004-4725	1 / 25	.401	48
RS4004-4732	1-1/4 / 32	.401	48

## FLUSH MUSHROOM RIVET SETS 3/4"



Part No.	Dia (in/mm)	Shank Size	OAL (in/mm)
RS4108-4719	3/4 / 19	.401	2-1/2 / 64

## FLUSH MUSHROOM RIVET SET 1"

Longer ones for reaching into areas where you need just a bit more length than a standard-length flush provides.



Part No.	Rivet Size	Shank Size	OAL (in/mm)
RS4108-4725	1 / 25	.401	2-1/2 / 64
RS4408-4725	1 / 25	.401	5-1/2 / 140
RS4508-4725	1 / 25	.401	7-1/2 / 190

## FLUSH MUSHROOM RIVET SET 1-1/4"



Part No.	Dia (in/mm)	Shank Size	OAL (in/mm)
RS4208-4732	1-1/4 / 32	.401	3-1/2 / 90

## FLUSH RIVET SET 2"



Part No.	Dia (in/mm)	Shank Size	OAL (in/mm)
RS4004-4751	2 / 51	.401	3 / 76

## FLUSH MUSHROOM RIVET SET 3/4" – OFFSET 10°



Part No.	Dia (in/mm)	Shank Size	OAL (in/mm)
RS4209-4719	3/4 / 19	.401	3 / 75

## FLUSH RIVET SET 1" – OFFSET 10°

Longer ones for reaching into areas where you need just a bit more length than a standard-length flush provides.



Part No.	Rivet Size	Shank Size	OAL (in/mm)
RS4309-4725	1 / 25	.401	3-1/2 / 90
RS4409-4725	1 / 25	.401	5-1/2 / 140
RS4509-4725	1 / 25	.401	7-1/2 / 190

## FLUSH SET – SWIVEL

The swivel face of this rivet set allows for off-angle riveting of awkward to get-to fasteners.



Part No.	Dia (in/mm)	Shank Size	OAL (in/mm)
RS4207-4719	3/4 / 19	.401	3 / 76

## FLUSH SET – SWIVEL

The swivel face of this rivet set allows for off-angle riveting of awkward to get-to fasteners.



Part No.	Dia (in/mm)	Shank Size	OAL (in/mm)
RS4207-4732	1-1/4 / 32	.401	3 / 76

## FLUSH RIVET SET – MUSHROOM WITH RUBBER GUARD

Rubber ring around the face to prevent damage to aircraft skin



Part No.	Dia (in/mm)	Shank Size	OAL (in/mm)
RS4210-4719	3/4 / 19	.401	2-3/8 / 60
RS4210-4725	1 / 25	.401	2-3/8 / 60
RS4210-4732	1-1/2 / 32	.401	2-3/8 / 60

### FLUSH SET – NO-MAR, BRASS FACE

Brass face often used to install Hi-Loks and other fasteners without causing damage to the fastener's head (Brass face not replaceable)



Part No.	Dia (in/mm)	Shank Size	OAL (mm)
RS4201-4719	3/4" / 19	.401	79
RS4201-4725	1 1/25mm	.401	3-1/8

### FLUSH SET – NO-MAR, NYLON FACE

This nylon rivet set is designed to reduce potential damage (Nylon face not replaceable)



Part No.	Dia (in/mm)	Shank Size	OAL (in)
RS4202-4725	1 1/25mm	.401	3-1/8

### FLUSH SET – NO-MAR, ALUMINIUM FACE

This aluminium rivet set is designed to reduce potential damage (Aluminium face not replaceable)



Part No.	Dia (in/mm)	Shank Size	OAL (in)
RS4203-4725	1 1/25mm	.401	3-1/8

### FLUSH SET – NO-MAR SET OF 3

No-mar flush set of 3. Includes brass, nylon and aluminium face rivet sets.



Part No.	Dia (in/mm)	Shank Size	OAL (in)
RS4201-2300	1 1/25mm	.401	3-1/8

### RIVET SET – SUICIDE FLUSH



Part No.	Dia (in/mm)	Shank Size	OAL (in/mm)
RS4308-4713	13	.401	3-1/2 / 90

### FLUSH "T" SET

Perfect for accessing tight awkward areas..



Part No.	Description	Shank Size	OAL
RS4804	Flush T Set	.401	5 3/4 / 145mm

### RIVET SET – OFFSET FLUSH "J" SET

Flush face is at 60° and is ideal for reaching around obstacles into limited access areas.



Part No.	Description	Shank Size	OAL (mm)
RS4812	Offset Flush J Set	.401	165

### RIVET SET – C-SHAPE 60° FLUSH

Flush face is at 60° and is ideal for accessing hard to reach areas.



Part No.	Description	Shank Size	OAL (mm)
RS 4806	Flush "C" Rivet Set	.401	165

### RIVET SET – C-SHAPE 90° WITH 3/16" HOLE

- "C" shape Rivet set accepting standard 3/16" shank Rivet Squeezer Sets
- Allows for installation of rivets in hard to access area
- Inside measurement of "C" is 75mm high x 34mm deep



Part No.	Description	Shank Size	OAL (mm)
RS4805	"C" Rivet Set	.401	159

### FLAT CHISEL RIVET SET



Part No.	Description	Shank Size	OAL
RS4808	Chisel Rivet Set	.401"	140mm

### RIVET SET – ELEPHANT LEG

- Unique Rivet set accepting standard 3/16" shank Rivet Squeezer Sets
- Offset foot on Rivet Set is 38mm long allowing for installation of rivets in hard to access areas



Part No.	Description	Shank Size	OAL (mm)
RS4807	Elephant Leg Rivet Set	.401	114

### KNOCKOUT PUNCHES



Part No.	Shank Size	OAL	Rivet Size
RS4008-4703	.401	90mm	3/32"
RS4008-4704	.401	90mm	1/8"
RS4008-4705	.401	90mm	5/32"
RS4008-4706	.401	90mm	3/16"
RS4008-4707	.401	90mm	7/32"
RS4008-4708	.401	90mm	1/4"
RS4008-4709	.401	90mm	5/16"
RS4008-4710	.401"	90mm	3/8"

### EXTRA LONG KNOCKOUT PUNCHES



Part No.	Shank Size	OAL	Rivet Size
RS4009-4703	.401	90mm	3/32"
RS4009-4704	.401	90mm	1/8"
RS4009-4705	.401	90mm	5/32"
RS4009-4706	.401	90mm	3/16"
RS4009-4707	.401	90mm	7/32"
RS4009-4708	.401	90mm	1/4"
RS4009-4709	.401	90mm	5/16"
RS4009-4710	.401	90mm	3/8"
RS4010-4706	.498	90mm	3/16"
RS4010-4708	.498	90mm	1/4"
RS4010-4709	.498	90mm	5/16"
RS4010-4710	.498	90mm	3/8"

### OFFSET KNOCKOUT PUNCH – WITCHES FINGER



Part No.	Description	Diameter	OAL
RS4011-4704	Offset K/O Punch	5/32"	10"
RS4011-4705	Offset K/O Punch	1/8"	10"
RS4011-4706	Offset K/O Punch	3/16"	10"
RS4011-4708	Offset K/O Punch	1/4"	10"

### SWIVEL DIMPLING TOOLS – FEMALE



Part No.	Shank Size	Style	OAL	Rivet Size
RS4317-4703	.401	Female	90mm	3/32"
RS4317-4704	.401	Female	90mm	1/8"
RS4317-4705	.401	Female	90mm	5/32"
RS4317-4706	.401	Female	90mm	3/16"

### SWIVEL DIMPLING TOOLS – MALE



Part No.	Shank Size	Style	OAL	Rivet Size
RS4316-4703	.401	Male	90mm	3/32"
RS4316-4704	.401	Male	90mm	1/8"
RS4316-4705	.401	Male	90mm	5/32"
RS4316-4706	.401	Male	90mm	3/16"

### JIFFY SHORT SHANK RIVET SETS



Part No.	Shank Size	OAL	Rivet Size
RS4004-4703	.401"	32mm	3/32"
RS4004-4704	.401"	32mm	1/8"
RS4004-4705	.401"	32mm	5/32"
RS4004-4706	.401"	32mm	3/16"
RS4004-4708	.401"	32mm	1/4"

### JIFFY FLUSH RIVET SETS



Part No.	Style	Shank Size	OAL	Diameter
RS4006-4713	Straight	.401"	32mm	13mm
RS4007-4713	Offset	.401"	45mm	13mm

### JIFFY OFFSET SHORT SHANK RIVET SETS



Part No.	Shank Size	OAL	Rivet Size
RS4005-4703	.401"	45mm	3/32"
RS4005-4704	.401"	45mm	1/8"
RS4005-4705	.401"	45mm	5/32"
RS4005-4706	.401"	45mm	3/16"
RS4005-4708	.401"	45mm	1/4"



### HUCK/HI-LOK® COLLAR REMOVERS



Part No.	Shank Size	OAL	Rivet Size
RS4415-4704	.401"	140mm	1/8"
RS4415-4705	.401"	140mm	5/32"
RS4415-4706	.401"	140mm	3/16"
RS4415-4708	.401"	140mm	1/4"
RS4415-4709	.401"	140mm	5/16"
RS4415-4710	.401"	140mm	3/8"

### RIVET SET EXTENDER

Extend any .401 shank by 200mm



Part No.	Description	Shank Size
RS4511-4700	Rivet Set Extender 8"	.401

### NO-MAR BACK RIVET SHOOTER

Spring-loaded guard holds down skin while back-riveting.



Part No.	Shank Size	Diameter	OAL
RS1049	.401	3/8"	5 3/4"

### SHANK SLEEVE ADAPTER

Shank adapter sleeve converts any .401" rivet set to a .498" shank where space is limited.



Part No.	Rivet Set Shank Size	Air Tool Shank
RS4013	.401	.498"

### RIVET SETS – BAC MODIFIED UNIVERSAL (BACR 15FT)

Universal Cutaway Rivet Sets



Part No.	Rivet Size	Shank Size	OAL (in/mm)
RS4313-4703	3/32"	.401	3-1/2 / 90
RS4313-4704	1/8"	.401	3-1/2 / 90
RS4313-4705	5/32"	.401	3-1/2 / 90
RS4313-4706	3/16"	.401	3-1/2 / 90
RS4313-4708	1/4"	.401	3-1/2 / 90

### PHENOLIC SCRAPER FOR RIVET GUN

- Suits standard .401 Rivet Guns
- Can be used as a hand held Scraper
- Non conductive & non-sparking

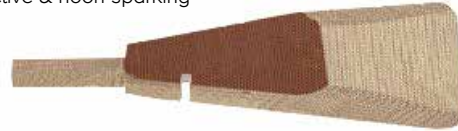

Part No.	Description
SC2002	Phenolic Rivet Gun Scraper

### RIVET SET SHANK ADAPTERS



Part No.	Rivet Set Shank Size	Air Tool Shank Size	OAL
RS4011	.498	.401	95mm
RS4012	.401	.498	95mm

### "OLD MAN" SCREW KNOCKER REMOVER TOOL

- Standard .401 shank to fit rivet gun for removing stubborn screws
- 3/8" Drive accepts sockets or 1/4 bit adapter available separately



Part No.	Description
RS4809	200mm Screw Knocker
RS4810	100 mm Screw Knocker
720138	3/8" Drive - 1/4" Bit Holder

### RIVET SETS – BAC MODIFIED OFFSET (BAC 15FT)

Universal Cutaway Rivet Sets



Part No.	Rivet Size	Shank Size	OAL (in/mm)
RS4314-4703	3/32"	.401	3-1/2 / 90
RS4314-4704	1/8"	.401	3-1/2 / 90
RS4314-4705	5/32"	.401	3-1/2 / 90
RS4314-4706	3/16"	.401	3-1/2 / 90
RS4314-4708	1/4"	.401	3-1/2 / 90

### RIVET TYPE CHART

Note: The Rivet sets shown below suit AN450 Semi Tubular Rivets

AN 470 Universal	AN 430 Round	AN 435 Button	AN 442 Flat	AN 450 Semi-Tubular	AN 455 Brazier	AN 456 Mod. Brazier	AN 426 Countersunk	BACR 15FT Brilles Boeing

### TUBULAR RIVET SETS AN450

Select the required rivet set (first chart), then add the desired cupping (second chart). Example: 07-10-4504



.401 Shank		Size	Rivet Type	Length
Straight	Offset			
RS4710-4502	RS4720-4502	1/16"	AN450	3-1/2" / 89MM
RS4710-4503	RS4720-4503	3/32"	AN450	3-1/2" / 89MM
RS4710-4504	RS4720-4504	1/8"	AN450	3-1/2" / 89MM
RS4710-4505	RS4720-4505	5/32"	AN450	3-1/2" / 89MM
RS4710-4506	RS4720-4506	3/16"	AN450	3-1/2" / 89MM
RS4710-4508	RS4720-4508	1/4"	AN450	3-1/2" / 89MM
RS4710-4510	RS4720-4510	5/16"	AN450	3-1/2" / 89MM
RS4711-4502	RS4721-4502	1/16"	AN450	5-1/2" / 140MM
RS4711-4503	RS4721-4503	3/32"	AN450	5-1/2" / 140MM
RS4711-4504	RS4721-4504	1/8"	AN450	5-1/2" / 140MM
RS4711-4505	RS4721-4505	5/32"	AN450	5-1/2" / 140MM
RS4711-4506	RS4721-4506	3/16"	AN450	5-1/2" / 140MM
RS4711-4508	RS4721-4508	1/4"	AN450	5-1/2" / 140MM
RS4711-4510	RS4721-4510	5/16"	AN450	5-1/2" / 140MM
RS4712-4502	RS4722-4502	1/16"	AN450	7-1/2" / 191MM
RS4712-4503	RS4722-4503	3/32"	AN450	7-1/2" / 191MM
RS4712-4504	RS4722-4504	1/8"	AN450	7-1/2" / 191MM
RS4712-4505	RS4722-4505	5/32"	AN450	7-1/2" / 191MM
RS4712-4506	RS4722-4506	3/16"	AN450	7-1/2" / 191MM
RS4712-4508	RS4722-4508	1/4"	AN450	7-1/2" / 191MM
RS4712-4510	RS4722-4510	5/16"	AN450	7-1/2" / 191MM

### RIVET TAPE

- Securely holds rivets in place until you are ready to install them
- The centre section is non-adhesive and rivets are clearly visible through this "centre window"
- A major time saver



Part No.	Description	Size
RT6851	Rivet Tape	19mm x 65.8m
RT6852	Rivet Tape	25mm x 65.8m

### SNAP-SOC™ RIVET SET CAPS

- An inexpensive solution to rivet head damage
- Colour coded for rivet size
- Lasts for about 50-75 rivets before needing to be replaced



Part No.	Description	Rivet Size	Qty
SS4033	Snap-Soc™ Rivet Caps	3/32"	10
SS4018	Snap-Soc™ Rivet Caps	1/8"	10
SS4053	Snap-Soc™ Rivet Caps	5/32"	10
SS4031	Snap-Soc™ Rivet Caps	3/16"	10
SS4014	Snap-Soc™ Rivet Caps	1/4"	10

### SHOP HEAD RIVET GAGE



Part No.	Description
GR1001	Rivet Gage Set

### RIVET LENGTH GAGE

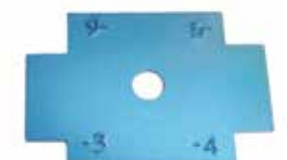

Part No.	Description
GR1002	Rivet Length Gage

# Tungsten Bucking Bars

Tungsten Bucking bars have been found to be very useful in the application of a dolly, being very heavy for their size and very hard. It must be pointed that tungsten is actually a brittle material. Considering the price of tungsten bars, we feel we must warn our customers to handle these bars with some care. The fact that they are used in a rivet/hammering application, we cannot guarantee that the bar will not break if you dropped it or used it for any application other than setting of rivets

BUCKING BAR, TUNGSTEN



Part No.	Description	Size LxWxH	Weight
BB1205	Tungsten Bucking Bar	140 x 38 x 13mm	1.27kg

BUCKING BAR, TUNGSTEN



Part No.	Description	Size LxWxH	Weight
TSBB-02	Tungsten Bucking Bar	-	1.39kg

BUCKING BAR, TUNGSTEN



Part No.	Description	Size LxWxH	Weight
TSBB-01	Tungsten Bucking Bar	-	0.75kg

BUCKING BAR, TUNGSTEN



Part No.	Description	Size LxWxH	Weight
BB1103	Tungsten Bucking Bar	64 x 38 x 19mm	0.75kg

BUCKING BAR, TUNGSTEN



Part No.	Description	Size LxWxH	Weight
BB1100	Tungsten Bucking Bar	51 x 38 x 16mm	0.52kg

BUCKING BAR, TUNGSTEN



Part No.	Description	Size LxWxH	Weight
BB1117	Tungsten Bucking Bar	70 x 51 x 19mm	1.15kg

BUCKING BAR, TUNGSTEN



Part No.	Description	Size LxWxH	Weight
BB1102	Tungsten Bucking Bar	63 x 51 x 25mm	1.28kg

BUCKING BAR, TUNGSTEN



Part No.	Description	Size LxWxH	Weight
BB1105	Tungsten Bucking Bar	64 x 32 x 25mm	0.73kg

BUCKING BAR, TUNGSTEN



Part No.	Description	Size LxWxH	Weight
BB1119	Tungsten Bucking Bar	73 x 51 x 25mm	1.2kg

BUCKING BAR, TUNGSTEN



Part No.	Description	Size LxWxH	Weight
BB1107	Tungsten Bucking Bar	51 x 32 x 25mm	0.60kg

BUCKING BAR, TUNGSTEN



Part No.	Description	Size LxWxH	Weight
BB1106	Tungsten Bucking Bar	51 x 35 x 19mm	0.66kg

BUCKING BAR, TUNGSTEN



Part No.	Description	Size LxWxH	Weight
BB1190	Tungsten Bucking Bar	102x51x25mm	1.39kg

BUCKING BAR, TUNGSTEN



Part No.	Description	Size LxWxH	Weight
BB1109	Tungsten Bucking Bar	64 x 51 x 25mm	1.0kg

BUCKING BAR, TUNGSTEN



Part No.	Description	Size LxWxH	Weight
BB1112	Tungsten Bucking Bar	152 x 38 x 19mm	1.27kg

BUCKING BAR, TUNGSTEN



Part No.	Description	Size LxWxH	Weight
BB1252	Tungsten Bucking Bar	102x38x19mm	0.79kg

BUCKING BAR, TUNGSTEN



Part No.	Description	Size LxWxH	Weight
BB1115	Tungsten Bucking Bar	111 x 38 x 25	0.92kg

BUCKING BAR, TUNGSTEN



Part No.	Description	Size LxWxH	Weight
BB1118	Tungsten Bucking Bar	126 x 38 x 38mm	1.1kg

BUCKING BAR, TUNGSTEN



Part No.	Description	Size LxWxH	Weight
BB1160	Tungsten Bucking Bar	101 x 80 x 19mm	0.91kg



BUCKING BAR, TUNGSTEN



Part No.	Description	Size LxWxH	Weight
BB1113	Tungsten Bucking Bar	64 x 19 x 102mm	1.26kg

BUCKING BAR, TUNGSTEN



Part No.	Description	Size LxWxH	Weight
BB1108	Tungsten Bucking Bar	95 x 51 x 25mm	2.3kg

BUCKING BAR, STEEL



Part No.	Description	Size LxWxH	Weight
BB1141	Bucking Bar	263 x 25 x 78mm	1.631kg

BUCKING BAR, STEEL



Part No.	Description	Size LxWxH	Weight
BB1078	Bucking Bar	109 x 51 x 26mm	1.071kg

BUCKING BAR, STEEL



Part No.	Description	Weight
BB1149	Bucking Bar	2.2 lbs / 1.0 kg

BUCKING BAR, STEEL



Part No.	Description	Weight
BB1140	Bucking Bar	1.5 lbs / 0.68 kg

## Steel Bucking Bars

BUCKING BAR, STEEL



Part No.	Description	Weight
BB1037	Bucking Bar	1 lbs / 0.45 kg

BUCKING BAR, STEEL



Part No.	Description	Weight
BB1750	Bucking Bar	1.25 lbs / 0.57 kg

BUCKING BAR, STEEL – T-SHAPE



Part No.	Description	Weight
BB1036	Bucking Bar T-Shape	1.5 lbs / 0.68 kg

BUCKING BAR, STEEL



Part No.	Description	Weight
BB1161	Bucking Bar	1.1 lbs / 0.5 kg

BUCKING BAR, STEEL



Part No.	Description	Size LxWxH	Weight
BB1154	Bucking Bar	163 x 38 x 38mm	1.39kg

BUCKING BAR, STEEL



Part No.	Description	Size LxWxH	Weight
BB1074	Bucking Bar	76 x 40 x 33mm	0.55kg

BUCKING BAR, STEEL



Part No.	Description	Size LxWxH	Weight
BB1080	Bucking Bar	97 x 42 x 25mm	0.56kg

BUCKING BAR, STEEL



Part No.	Description	Size LxWxH	Weight
BB1082	Bucking Bar	100 x 25 x 50mm	0.62kg

BUCKING BAR, STEEL



Part No.	Description	Weight
BB1153	Bucking Bar	1.4 lbs / 0.64 kg

BUCKING BAR, STEEL



Part No.	Description	Weight
BB1150	Bucking Bar	1.2 lbs / 0.55 kg

BUCKING BAR, STEEL – HEEL & TOE



Part No.	Description	Size LxWxH	Weight
BB1029	Bucking Bar Heel & Toe	163 x 25 x 78mm	0.91kg

BUCKING BAR, STEEL



Part No.	Description	Size LxWxH	Weight
BB1147	Bucking Bar	135 x 27 x 29mm	0.68kg





# Other Rivet Squeezers

## GENERAL PNEUMATIC TOOLS – C YOKE RIVETER

- Powerful single cylinder rivet compression tool.
- Comes complete with 1-1/2" reach jaw (base unit can easily be fitted with other size jaws for different applications).
- Easily squeezes up to 1/8" diameter rivets.
- Accepts industry standard .187(3/16") shank squeezer sets.
- Made in the USA!



Part No.	Cylinder	Reach	Capacity	Length
3000C-1-1/2	Single	38mm	1/8"	260mm
3000C-2	Single	51mm	1/8"	260mm
3000C-3	Single	76mm	1/8"	260mm

## GENERAL PNEUMATIC TOOLS – ALLIGATOR YOKE RIVETER

- A lightweight single cylinder "alligator" type squeezer designed to easily install solid rivets in many applications.
- Comes complete with jaws.
- 3000 lbs of pressure to easily handle up to 1/8" diameter rivets.
- Made in the USA!



Part No.	Cylinder	Reach	Capacity	Length
3000A-1-1/2	Single	38mm	1/8"	235mm
3000A-2	Single	51mm	1/8"	235mm
3000A-3	Single	76mm	1/8"	235mm

## GENERAL PNEUMATIC TOOLS – C YOKE RIVETER

- Features twin tandem cylinders for added power.
- 6000 lbs of total compressive force, this tool provides maximum power with minimal weight.
- Accepts industry standard .187 shank squeezer sets.
- Will easily squeeze up to 3/16" diameter rivets.
- Made in the USA!



Part No.	Cylinder	Reach	Capacity	Length
6000C-1-1/2	Tandem	38mm	3/16"	355mm
6000C-2	Tandem	51mm	3/16"	355mm
6000C-3	Tandem	76mm	3/16"	355mm

## GENERAL PNEUMATIC TOOLS – ALLIGATOR YOKE RIVETER

- Twin tandem cylinder for twice the power of a standard single cylinder tool.
- The rivet capacity depends on the length of reach of the jaws – it is always best to choose the shortest jaws that will work for your application.
- 3/16" aluminum rivet capacity (5/32" steel)
- 6000 lbs of squeezing force.
- Uses industry standard 3/16" shank squeeze sets.
- Swivel air fitting included.
- Made in the USA!



Part No.	Cylinder	Reach	Capacity	Length
6000A-1-1/2	Tandem	38mm	3/16"	305mm
6000A-2	Tandem	51mm	3/16"	305mm
6000A-3	Tandem	76mm	3/16"	305mm

## TAYLOR 3 PIECE PNEUMATIC SQUEEZER SET

- The squeezer develops a 3000lb of compression force
- Rated for 1/8" rivets
- Heat treated yokes prevent rust and provide long life
- Yokes interchangeable with CP style squeezers
- One year warranty

Contents:

- Taylor C type squeezer
- Z standard 3" reach yoke
- 2-1/2" "longer-on" yoke



Part No.	Description	Weight (Squeezer)	OAL (Squeezer)
T-3000C-2Y	3 Piece Pneumatic Squeezer Set	1.82kg	262mm

## TAYLOR STANDARD C YOKE

- Excellent quality, precision machined from tool steel and perfectly heat treated.
- Black oxide finish to resist rusting
- Upper arm accepts industry standard 3/16" shank rivet squeezer dies
- Industry standard yoke hole pattern will work with all known brands of single cylinder "C" type pneumatic rivet squeezers



Part No.	Description	Reach	Gap
CY-3215	1 1/2" C Type Squeezer Yoke	1-1/2"	1-1/4"
CY-7530	3" C Type Squeezer Yoke	3"	1-1/4"

## TAYLOR 2-1/2" YOKE "LONGER-ON" VERSION

- One of our most popular yokes - our "Longeron Yoke" gives you 2-1/2" of reach with more height clearance than standard yokes
- The upper arm has an extra 3/4" of clearance which gives you a total height of 2" to work with
- This yoke is perfect for working over obstructions such as longerons, angles, and stiffeners
- Excellent quality, precision machined from tool steel and perfectly heat treated
- Black oxide finish to resist rusting
- Upper arm accepts industry standard 3/16" shank rivet squeezer dies
- Industry standard yoke hole pattern will work with all known brands of single cylinder "C" type pneumatic rivet squeezers



Part No.	Description
CY-6325	2-1/2" Yoke "LongerOn" Version

## FOOT CONTROL CONVERSION KIT

- Converts standard lever-operated compression riveters to foot-operation, freeing up both hands so that the item being riveted can be positioned easily.
- Conversion kit includes a foot control unit plus all required hardware to turn your pneumatic squeezer tool into a foot operated tool.



Part No.	Description
FC 1259	Foot Control Conversion Kit

## ADJUSTABLE SET HOLDER

- Will fit any known brand of single cylinder C rivet squeezer
- Eliminates the need for use of shims or different squeeze sets
- Precisely adjustable, each full revolution raises or lowers the set holder .0312"



Part No.	Description
AS 1240	Adjustable Set Holder



# Manual Rivet Squeezers

## TATCO® SQUEEZER

- High quality stainless steel hand squeezer
- Yokes are simply interchanged by removal of three roll pins
- Made in the USA



Part No.	Description
THS1S	1 1/2" Rivet Squeezer
THS20	2" Rivet Squeezer
THS30	3" Rivet Squeezer
THS40	4" Rivet Squeezer

## TATCO® YOKES



Part No.	Description	Size / Reach
THY10	Tatco Yoke	25mm
THY15	Tatco Yoke	38mm
THY20	Tatco Yoke	50mm
THY25	Tatco Yoke	63mm
THY30	Tatco Yoke	75mm
THY35	Tatco Yoke	89mm
THY40	Tatco Yoke	101mm
THY50	Tatco Yoke	127mm
THY60	Tatco Yoke	152mm
THY101	Tatco No-Hole Yoke	25mm
THY22	Tatco "Longer-On" Yoke	50mm

## QUICK CHANGE YOKE PIN

- For use with stainless steel hand squeezer and economy hand squeezer.
- With pull rings
- Swap yokes quickly and easily when you need a different reach.



Part No.	Description	OAL
121-3/4	For Stainless Steel Hand Squeezer	3/4 inch

## TATCO® SQUEEZER KIT

Consists of 1 x THS15 Squeezer, 1 x THY30 Yoke and 6 x squeezer sets (3/32", 1/8", 5/32", 3/16" and 2 x Flush)



Part No.	Description
THY500	Tatco Squeezer Kit

## HENCHMAN HAND SQUEEZERS – STAINLESS STEEL

- Stainless steel
- Light weight and extremely durable
- Yokes are interchanged by removing three pins
- Adjustable set holder accepts dies and sets with 3/16" shank.



Part No.	Description	Yoke
H-16300	Hand Rivet Squeezer	1-1/2 inch
H-16306	Hand Rivet Squeezer	3 inch

## HENCHMAN YOKES – STAINLESS STEEL



Part No.	Ref	Description	Size
H-16301	A	Yoke	1-1/2 inch
H-16302	B	Yoke	2 inch
H-16302+	C	Yoke	2 x 2 inch
H-16303	D	Yoke	3 inch
H-16304	E	Yoke	4 inch

## 8 PIECE DIMPLE DIE KIT

As listed in the table below



Part No.	Description
SD 2000	Dimple Die Kit Set of 8

## DIMPLE DIE SETS

- 2 Piece set consisting of both male and female dies.
- Suitable for use in hand squeezers or pneumatic squeezers
- Highly polished faces with .187" shanks



Part No.	Rivet Size
SD1933	3/32" Die Set
SD1918	1/8" Die Set
SD1953	5/32" Die Set
SD1931	3/16" Die Set
SD1914	1/4" Die Set
SD1006	#6 Screw
SD1008	#8 Screw
SD1010	#10 Screw

## DELUXE TATCO® SQUEEZER KIT

- Made in the USA
- Contents:
- TATCO Rivet Squeezer
  - 3 interchangeable yokes: 1-1/2", 2", & 3"
  - Custom fitted box with precision cut foam for quick and easy tool box storage.
  - 6 Squeezer Sets: 3/32", 1/8", 5/32" and 3/16" Cupped; 2 Flush.



Part No.	Description
THY600	Deluxe Tatco Squeezer Kit

## FLUSH SQUEEZER SETS



AN 470 Universal



Part No.	Shank Size	Face Dia.	Body Length
SF 0903	.187"	3/8"	1/8"
SF 0906	.187"	3/8"	1/4"
SF 0909	.187"	3/8"	3/8"
SF 0913	.187"	3/8"	1/2"
SF 0916	.187"	3/8"	5/8"
SF 0919	.187"	3/8"	3/4"
SF 1303 *	.187"	1/2"	1/8"
SF 1306 *	.187"	1/2"	1/4"
SF 1309 *	.187"	1/2"	3/8"
SF 1313 *	.187"	1/2"	1/2"
SF 1316	.187"	1/2"	5/8"
SF 1319	.187"	1/2"	3/4"

## 19 PIECE SQUEEZER KIT IN BOX

- Contents:
- 15 x Cupped Squeezer Sets
  - 4 x Flush Rivet Sets
  - in two-coloured Foam
  - Including Laser Marking on top layer



Part No.	Description
SS 1000	19 Piece Squeezer Kit

## HENCHMAN SQUEEZER KIT

- Contents:
- Stainless Steel Hand Squeezer
  - 2 interchangeable Yokes: 1-1/2 and 3 inch
  - Flush Sets 1/2in: 1/8, 1/4, 3/8 and 1/2 inch
  - Cupped Sets: 3/32, 1/8, 5/32, 3/16 inch
  - Dimple Dies: 3/32, 1/8, 5/32, 3/16 inch
  - 3 Quick Change Yoke Pins
  - Supplied in a carrying case and two-coloured foam



Part No.	Description
H-76200	Henchman Squeezer Kit

## CUPPED SQUEEZER SETS



AN 470 Universal



Part No.	Rivet Size	Shank Size	Body Length
SC 0303	3/32"	.187"	1/8"
SC 0603 *	3/32"	.187"	1/4"
SC 0903 *	3/32"	.187"	3/8"
SC 1303 *	3/32"	.187"	1/2"
SC 1603	3/32"	.187"	5/8"
SC 1903	3/32"	.187"	3/4"
SC 0304	1/8"	.187"	1/8"
SC 0604 *	1/8"	.187"	1/4"
SC 0904 *	1/8"	.187"	3/8"
SC 1304 *	1/8"	.187"	1/2"
SC 1604	1/8"	.187"	5/8"
SC 1904	1/8"	.187"	3/4"
SC 0305	5/32"	.187"	1/8"
SC 0605 *	5/32"	.187"	1/4"
SC 0905 *	5/32"	.187"	3/8"
SC 1205 *	5/32"	.187"	1/2"
SC 1605	5/32"	.187"	5/8"
SC 1905	5/32"	.187"	3/4"
SC 0306	3/16"	.187"	1/8"
SC 0606 *	3/16"	.187"	1/4"
SC 0906 *	3/16"	.187"	3/8"
SC 1306 *	3/16"	.187"	1/2"
SC 1606	3/16"	.187"	5/8"
SC 1906	3/16"	.187"	3/4"
SC 0608 *	1/4"	.187"	1/4"
SC 0908 *	1/4"	.187"	3/8"
SC 1308 *	1/4"	.187"	1/2"
SC 1608	1/4"	.187"	5/8"
SC 1908	1/4"	.187"	3/4"

HI-LOK® is a registered trademark of the HI-Shear and Fairchild Fasteners

# Gage Bilt Riveters

The GP704F series are pneumatic-hydraulic tools designed specifically for the efficient installation of a wide range of blind rivets. They can be operated in any position with one hand. They have a rated pull load of 3300 pounds with 90 psi air pressure at the air inlet.

- Aerospace Blind Rivets
- 'U' Type
- Cherrymax® Type
- All materials thru 3/16"

## POWERMAX RIVETER FOR CHERRYMAX® FASTENERS

- Designed to install all 1/8", 5/32" & 3/16" CherryMax® style fasteners
- Pulling heads for the GP704 are interchangeable with CherryMax® tools



Part No.	Description
GB704	PowerMAX Riveter

## AIR BLEEDER ASSEMBLY

Hydraulic systems of pneumatic tools need to be kept free of air. The air bleeder quickly removes air from the system



Part No.	Description
GB704153	Air Bleeder Assy

## STEM CATCHER BAGS

- Convenient accessory that helps eliminate FOD.
- Equipped with a heavy-duty zipper with a Velcro band that holds it securely in place to catch the spent rivet stems as they are ejected.
- See tool manual for part numbers.
- 704214 is equivalent to Cherry® 670A20



Part No.	Description
GB704214	Stem Catcher Bag Vinyl – rear-ejecting
GB756610	Stem Catcher Bag Cotton– rear-ejecting

## POWERMAX SPLIT RIVETER FOR CHERRYMAX® FASTENERS

Unique "split" system providing the operator with an ergonomic tool with reduced hand held Weight

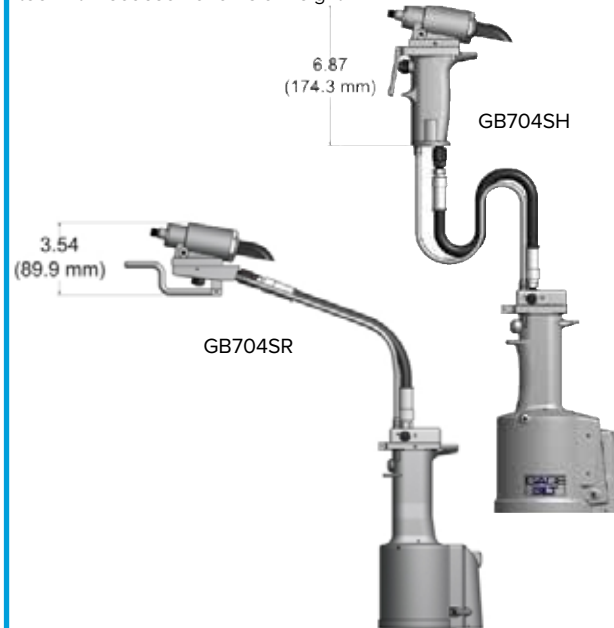

Part No.	Description
GB704SH	Split Riveter with 8 Foot Hose
GP704SR	Split Riveter with 3 Foot Hose
GP704SR-8	Split Riveter with 8 Foot Hose

## GB704 BLIND RIVETING KIT

- Includes: 3 x Str., 1 x R/A, 1 x Offset Nose Pieces
- A complete tool kit for installing Huck and Cherry blind rivets per NAS9301-NAS9312, M7885, BACR15FP/FR and BACR15GF/GK. The kit contains a straight nose to install -4, -5 and -6 Diameter, bleeder bottle, pintail catcher bag and a grip selector gage, a right angle and an offset nose. All these items are stored in an easy access carrying case with a manual, data sheets, powermax tools manual and pocket card.



Part No.	Description
GB704RK-1	Deluxe Blind Rivet Kit

## NOSE ASSEMBLY SELECTION GUIDE FOR GB704

- 1) Installs 1/8", 5/32" and 3/16" diameters
- 2) Right Angle Nose Assemblies may require more than one pull
- 3) Front end ejecting Nose Assembly

Straight	Right Angle <sup>3</sup>	Offset	Dia.	Fastener
456MAX-701-17 <sup>1</sup>	456MAX-704-54RA <sup>1</sup>	456MAX-704-43OS <sup>1</sup>	1/8"	CHERRYMAX®, CHERRYMAX® 'AB', MBC® LOCK CREATOR BACR15FR/FP, BACR15GF/GK
456MAX-704-35 <sup>1</sup>			5/32"	
456MAX-749-35 <sup>1,3</sup>			3/16"	
3C-704A-16	3C-704-54RA	3C-704A-40OS	3/32"	Nut Plate Rivets MS20600 Series CCR244/264/274 MS/9SP/PT BACR15CC/CF/DA/DR
4C-704A-16	4C-704-54RA	4C-704A-40OS	1/8"	
5C-704A-16	5C-704-54RA	5C-704A-40OS	5/32"	
6C-704A-16	6C-704-54RA	6C-704A-40OS	3/16"	
3A-704A-16	3A-704-54RA	3A-704A-40OS	3/32"	'A' Code NAS1398A NAS1399A
4A-704A-16	4A-704-54RA	4A-704A-40OS	1/8"	
5A-704A-16	5A-704-54RA	5A-704A-40OS	5/32"	
6A-704A-16	6A-704-54RA	6A-704A-40OS	3/16"	
GS8-704-16	GS8-704A-54RA	GS8-704-40OS	8/32"	Ground Stud M83454 BACSS3R <sup>1</sup> EA1/2

## CHERRYMAX® & CHERRY® NUTPLATE HAND RIVETERS



Part No.	Description
GB27	CherryMAX® Hand Riveter 1/8"
GB29	Cherry® Nutplate Riveter 3/32" & 1/8"

## CHERRYMAX® HAND RIVET GUN

- Exceptional power with low hand effort for increased productivity.
- Mounting system (same as G704B) compatible with popular pulling heads including H782, H781-456 & H753A-456.
- 3/4" Stroke, up to 6000 lbs Pulling Force



Part No.	Description
G800	CherryMAX® G800 Hand Rivet Gun

## CHERRYMAX® HAND RIVET GUN KIT

Includes the G800 Hand Riveter, a straight pulling head, a right angle pulling head, an offset pulling head, an adapter assembly and a measuring and inspection gauge, all housed in a sturdy plastic carrying case.



Part No.	Description
G800CMR	CherryMAX® Hand Installation Tool

## NOSE ASSEMBLIES / PULLING HEADS



Straight (Example)



Right Angle (Example)



Offset (Example)

Part No.	Description
see selection guides	Pulling Heads

## PULLING HEAD EXTENSIONS



Part No.	Description	Length
704002	Pulling Head Extension	2"
704004	Pulling Head Extension	4"
704006	Pulling Head Extension	6"

## CHERRYMAX® HAND INSTALLATION TOOL

- Installs 1/8", 5/32", 3/16" and 1/4" Cherrymax®, Allmax®, & Huckmax® rivets
- .565 (14.35 mm) minimum stroke and a rated pull load of 3,500 lbs. (15.57 kN)

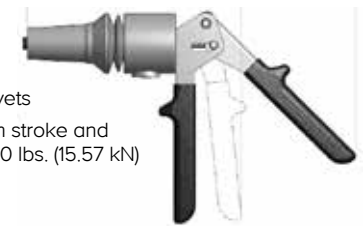

Part No.	Description
GB456A	CherryMAX® Hand Installation Tool

## NOSE ASSEMBLY SELECTION GUIDE FOR GB456A

- 1) Installs 1/8", 5/32" and 3/16" diameters
- 2) Right Angle Nose Assemblies may require more than one pull
- 3) Front end ejecting Nose Assembly
- 4) Requires 704001 Adapter

Straight	Right Angle <sup>3</sup>	Offset	Dia.	Fastener
456MAX-701-17 <sup>1</sup>	456MAX-704-54RA <sup>1,2</sup>	456MAX-704-43OS <sup>1</sup>	1/8"	CHERRYMAX®, CHERRYMAX® 'AB', MBC® LOCK CREATOR BACR15FR/FP, BACR15GF/GK, NAS1900 S & U Series Blind Rivet with Drive Washer
456MAX-704-35 <sup>1</sup>			5/32"	
456MAX-749-35 <sup>1,3</sup>			3/16"	
3C-715B-43 <sup>4</sup>	3C-704-54RA <sup>2</sup>	3C-704A-40OS	3/32"	Nut Plate Rivets MS20600 Series CCR244/264/274 MS/9SP/PT BACR15CC/CF/DA/DR
4C-715B-43 <sup>4</sup>	4C-704-54RA <sup>2</sup>	4C-704A-40OS	1/8"	
5C-715B-43 <sup>4</sup>	5C-704-54RA <sup>2</sup>	5C-704A-40OS	5/32"	
6C-715B-43 <sup>4</sup>	6C-704-54RA <sup>2</sup>	6C-704A-40OS	3/16"	
3A-715B-43 <sup>4</sup>	3A-704-54RA <sup>2</sup>	3A-704A-40OS	3/32"	'A' Code NAS1398A NAS1399A
4A-715B-43 <sup>4</sup>	4A-704-54RA <sup>2</sup>	4A-704A-40OS	1/8"	
5A-715B-43 <sup>4</sup>	5A-704-54RA <sup>2</sup>	5A-704A-40OS	5/32"	
6A-715B-43 <sup>4</sup>	6A-704-54RA <sup>2</sup>	6A-704A-40OS	3/16"	
GS8-715B-43 <sup>4</sup>			8/32"	Ground Stud M83454 BACSS3B1EA1/2
GS10-715B-43 <sup>4</sup>			10/32"	



### PNEUMATIC RIVETER

- Designed specifically for the most efficient installation of blind rivets. It will in-stall aluminum rivets through 5/32" diameter, and through 1/8" diameter rivets in any material. It weighs only 1.8 lbs. (0.82 kg) and can be operated in any position.
- 8.36" high, 740 (18.8 mm) stroke, generates a minimum of 700 lbs. (3.11 kN) pull load at 90 psi (6.2 bar). It operates on 90 to 100 psi (6.2-6.9 bar) of air pressure at the tool.
- Nose Assembly supplied separately



Part No.	Description
GB50	Pneumatic Rivet Installation Tool
GB50RK	Pneumatic Rivet Installation Kit

### PNEUMATIC RIVETER

- Designed specifically for the most efficient installation of blind rivets. It will install aluminum rivets through 3/16" diameter, and through 1/8" diameter rivets in any material. It weighs only 2 1/2 lbs. (1.13 kg) and can be operated in any position.
- 8.36" high, 740 (18.8 mm) stroke and generates a minimum of 1000 lbs. (4.45 kN) of pull at 90 psi. (6.2 bar). It operates on 90 to 100 psi (6.2-6.9 bar) of air pressure at the tool.
- Nose Assembly supplied separately



Part No.	Description
GB51	Pneumatic Rivet Installation Tool
GB51RK	Pneumatic Rivet Installation Kit

### PNEUMATIC RIVETER WITH COLLECTION BOTTLE

- Including a Collection Bottle for spent pin tails eliminating FOD
- Same stroke and load
- Nose Assembly supplied separately



Part No.	Description
GB54B	GB50 with Collection Bottle
GB55B	GB51 with Collection Bottle

### STEM CATCHER BAGS

- Convenient accessory that helps eliminate FOD.
- Equipped with a heavy-duty zipper with a Velcro band that holds it securely in place to catch the spent rivet stems as they are ejected.



Part No.	Description
GB500610	Stem Catcher Bag Cotton – side-ejecting xx-51-46
GB715610	Stem Catcher Bag Cotton – side-ejecting xx-715-43

### NOSE ASSEMBLY SELECTION GUIDE FOR GB50

Straight	Right Angle	Offset	Dia.	Fastener
3C-715B-43	3C-715A-54RA <sup>1</sup>	3C-715A-400S	3/32"	Nut Plate Rivets MS20600 Series
4C-715B-43	4C-715A-54RA <sup>1</sup>	4C-715A-400S	1/8"	CCR244/264/274 MS/9SP/PT
5C-715B-43	5C-715A-54RA <sup>1</sup>	5C-715A-400S	5/32"	BACR15CC/CF/DAVDR
3A-715B-43	3A-715A-54RA <sup>1</sup>	3A-715A-400S	3/32"	'A' Code NAS1398A
4A-715B-43	4A-715A-54RA <sup>1</sup>	4A-715A-400S	1/8"	NAS1399A
5A-715B-43	5A-715A-54RA <sup>1</sup>	5A-715A-400S	5/32"	NAS1738A
				NAS1739A
SMLS04-715B-43	SMLS04-715A-54RA <sup>1</sup>	SMLS04-715B-400S	1/8"	Blind Rivet (Single Action) with or W/out Drive Washer
SMLS05-715B-43	SMLS05-715A-54RA <sup>1</sup>	SMLS05-715B-400S	5/32"	NAS1900 S & U SERIES
MBC04-715C-43			1/8"	
MBC05-715C-43			5/32"	MBC® NAS1715-1721
MBC06-715C-43			3/16"	
3N-715E-43	3N-715A-54RA <sup>1</sup>	3N-715-400S	3/32"	
4N-715E-43	4N-715-54RA <sup>1</sup>	4N-715-400S	1/8"	Open End Nail Rivet
5N-715E-43	5N-715-54RA <sup>1</sup>	5N-715-400S	5/32"	
3N-715E-43	3N-715A-54RA <sup>1</sup>	3N-715-400S	3/32"	
4CEA-715E-43	4CEA-715-54RA <sup>1</sup>	4CEA-715-400S	1/8"	Closed End Nail Rivet (Aluminium Mandrel)
5CEA-715E-43	5CEA-715-54RA <sup>1</sup>	5CEA-715-400S	5/32"	
3N-715E-43	3N-715A-54RA <sup>1</sup>	3N-715-400S	3/32"	
4CES-715E-43	4CES-715-54RA <sup>1</sup>	4CES-715-400S	1/8"	Closed End Nail Rivet (Steel Mandrel)
5CES-715E-43	5CES-715-54RA <sup>1</sup>	5CES-715-400S	5/32"	
3C-715B-43	3C-715A-54RA <sup>1</sup>	3C-715A-400S	3/32"	
4C-715B-43	4C-715A-54RA <sup>1</sup>	4C-715A-400S	1/8"	FASTACK® AF5055
5C-715B-43	5C-715A-54RA <sup>1</sup>	5C-715A-400S	5/32"	
3A-715B-43	3A-715A-54RA <sup>1</sup>	3A-715A-400S	1/8"	
4A-715B-43	4A-715A-54RA <sup>1</sup>	4A-715A-400S	5/32"	SUPERTACK® AF5075 AF5076 S149A020

### NOSE ASSEMBLY SELECTION GUIDE FOR GB51

Straight	Right Angle	Offset	Dia.	Fastener
3C-715B-43	3C-715A-54RA <sup>3</sup>	3C-715A-400S	3/32"	Nut Plate Rivets MS20600 Series
4C-715B-43	4C-715A-54RA <sup>2</sup>	4C-715A-400S	1/8"	CCR244/264/274 MS/9SP/PT
5C-715B-43	5C-715A-54RA <sup>3</sup>	5C-715A-400S	5/32"	BACR15CC/CF/DAVDR
6C-715B-43	6C-715A-54RA <sup>1</sup>	6C-715A-400S	3/16"	
3A-715B-43	3A-715A-54RA <sup>1</sup>	3A-715A-400S	3/32"	'A' Code NAS1398A
4A-715B-43	4A-715A-54RA <sup>1</sup>	4A-715A-400S	1/8"	NAS1399A
5A-715B-43	5A-715A-54RA <sup>1</sup>	5A-715A-400S	5/32"	NAS1740A
6A-715B-43	6A-715A-54RA <sup>1</sup>	6A-715A-400S	3/16"	NAS1739A
SMLS04-715B-43	SMLS04-715A-54RA <sup>1</sup>	SMLS04-715B-400S	1/8"	Blind Rivet (Single Action) with or W/out Drive Washer
SMLS05-715B-43	SMLS05-715A-54RA <sup>1</sup>	SMLS05-715B-400S	5/32"	NAS1900 S & U SERIES
SMLS06-715B-43	SMLS06-715A-54RA <sup>1</sup>	SMLS06-715B-400S	3/16"	
456MAX-715-43	456MAX-715B-54RA	456MAX-715B-400S	1/8"	CHERRYMAX®, CHERRYMAX® 'AB', MBC® LOCK CREATOR BACR15FR/FP, BACR15GF/GK
MBC04-715C-43			1/8"	
MBC05-715C-43			5/32"	MBC® NAS1715-1721
MBC06-715C-43			3/16"	
3N-715E-43	3N-715A-54RA <sup>1</sup>	3N-715A-400S	3/32"	
4N-715E-43	4N-715-54RA <sup>1</sup>	4N-715A-400S	1/8"	Open End Nail Rivet
5N-715E-43	5N-715-54RA <sup>1</sup>	5N-715A-400S	5/32"	
6N-715E-43	6N-715-54RA <sup>1</sup>	6N-715A-400S	3/16"	
3N-715E-43	3N-715A-54RA <sup>1</sup>	3N-715A-400S	3/32"	
4CEA-715E-43	4CEA-715-54RA <sup>1</sup>	4CEA-715-400S	1/8"	Closed End Nail Rivet (Aluminium Mandrel)
5CEA-715E-43	5CEA-715-54RA <sup>1</sup>	5CEA-715-400S	5/32"	
6CEA-715E-43	6CEA-715-54RA <sup>1</sup>	6CEA-715-400S	3/16"	
3N-715E-43	3N-715A-54RA <sup>1</sup>	3N-715-400S	3/32"	
4CES-715E-43	4CES-715-54RA <sup>1</sup>	4CES-715-400S	1/8"	Closed End Nail Rivet (Steel Mandrel)
5CES-715E-43	5CES-715-54RA <sup>1</sup>	5CES-715-400S	5/32"	
3C-715B-43	3C-715A-54RA <sup>1</sup>	3C-715A-400S	3/32"	
4C-715B-43	4C-715A-54RA <sup>1</sup>	4C-715A-400S	1/8"	FASTACK® AF5022 AF5055
5C-715B-43	5C-715A-54RA <sup>1</sup>	5C-715A-400S	5/32"	
3A-715B-43	3A-715A-54RA <sup>1</sup>	3A-715A-400S	1/8"	
4A-715B-43	4A-715A-54RA <sup>1</sup>	4A-715A-400S	5/32"	SUPERTACK® AF5075 AF5076 S149A020
5A-715B-43	5A-715A-54RA <sup>1</sup>	5A-715A-400S	3/16"	

1) Right Angle Nose Assemblies may require more than one pull  
 2) Aluminium only  
 3) Self-plugging Aluminium only  
 4) Aluminium and Steel only  
 Note: The last 2 digits of the Nose Assembly represent the length the nose extends from the tool eg. -20 = 2.0 inches

### GAGE BILT CORDLESS BLIND RIVETER

- Stroke: 20 mm
- 3/16"
- 12V
- Power: 1800 lbf
- Weight (Incl. battery): 2.8 lbs.
- Brushless Motor
- Tool-free Maintenance
- Charging time: < 30 mins



Contents:  
 • RivdomZERO battery riveter incl. 12 V/2.0 Ah battery (number depending on variant) with optical charge state indicator, 4x standard nosepiece in box, Rivdom-PLUS quick charger, mandrel container, belt clip, hanger and cover cap in L-Boxx with coloured sales sleeve.

Part No.	Description
GB101	Gage Bilt Cordless Riveter RivdomZero

### GAGE BILT CORDLESS BLIND RIVETER

- Stroke: 1.181" (30 mm)
- 1/8"-1/4"
- 20V
- Rated Pull Load: 4,496 lbs. (20 kN)
- Sound Emissions: <65 / 3 LpA / K
- Vibrations: <2.5 / 1.5 ah / K m/s<sup>2</sup>
- Weight (Incl. battery): 4.4 lbs. (2 kg)
- Brushless Motor
- Tool-free Maintenance



Contents:  
 • RivdomTWO battery riveter incl. 20 V battery (number depending on variant) with optical charge state indicator, 4x standard nosepiece in box, Rivdom-PLUS quick charger, mandrel container and cover cap in L-Boxx with coloured sales sleeve.

Part No.	Description
GB108	Gage Bilt Cordless Riveter RivdomTwo

### GAGE BILT CORDLESS LOCKBOLT RIVETER

- Stroke: 1.181" (30 mm)
- 5/32"-1/4"
- 20V
- Rated Pull Load: 5,395 lbs. (24 kN)
- Sound Emissions: <65 / 3 LpA / K
- Vibrations: <2.5 / 1.5 ah / K m/s<sup>2</sup>
- Weight (Incl. battery): 4.6 lbs. (2.1 kg)
- Brushless Motor
- Tool-free Maintenance



Contents:  
 • RivdomTWOSF battery riveter incl. 20 V battery (number depending on variant) with optical charge state indicator, 4x standard nosepiece in box, Rivdom-PLUS quick charger, mandrel container and cover cap in L-Boxx with coloured sales sleeve.

Part No.	Description
GB110A	Gage Bilt Cordless Riveter RivdomTwoSF

Tool Cross- Reference Chart to Gage Bilt			
Tool #	Gage Bilt	Tool#	Gage Bilt
202	GBP752F	262B	GBP7262B
206-375	GBP206-375	2630	GBP2630
208-750	GBP208-750	G83	GBP730E
212	GBP713C	G84	GBP731
244	GBP731	G85	GBP745D
245	GBP745D	G200	GBP700
255	GBP745D	G703	GBP703E
585	GBP585	G704B	GBP704F
586	GBP586	G715	GBP715C
2013	GBP704F	G740	GBP740B
2015	GBP751D	G743A	GBP743C
2022	GBP743C	G744	GBP744A
2025	GBP722A	RV14GD	GBP715C
2480	GBP2480	RV30GD	GBP740A / 715
2580	GBP2581	RV50	GB50
256	GBP756	RV51	GB51
2620	GBP2620	PRG540	GBP743C

### BLIND BOLT RIVETING KIT

- For installing 2000 series CHERRYLOCK® rivets conforming to NAS1738-39 & NAS1398-99, 1/8" thru 3/16"
- 1/4" Nose Assembly (8C) can be ordered separately
- In an easy access carrying case with manual and data sheet

Contents:

- GB784 tool, bleeder bottle
- Straight noses to install -4, -5 and -6 Diameters
- Stroke setting gage
- Bleeder bottle



Blind Rivet	Dia.	Nose Assembly
	1/8"	4C-681-25
	5/32"	5C-681-25
	3/16"	6C-681-25

Part No.	Description
GB784RK	Blind Rivet Kit with 3 Nose Pieces (Straight only)

### BLIND BOLT RIVETING KIT

- For installing Huck and Cherry blind bolts 5/32" thru 3/16" per MS21140 & MS21141 (U or S) and MS90353 & MS90354 (U or S)
- In an easy access carrying case with manuals and data sheets.

GB752BBK Contents:

- Straight noses to install -5 and -6 Diameters
- Bleeder Bottle
- Pintail Catcher Bag
- Grip Selector Gage

GB752BBK-1 Contents:

- Right Angle Noses
- Offset Noses
- Stroke limiter

\* Noses listed protrude 2 Inches from the tool. Longer noses are available.

\*\* Required 752140 stroke limiter

For 4.5 Inches order SBxx-752B-45

For 8.0 Inches order SBxx-752B-80



Blind Rivet	Dia.	Nose Assembly		
		Straight	Right Angle	Offset
	5/32"	*SB05-752B-20	**SB05-751B-54RA	SB05-752A-43OS
	3/32"			
	3/16"	*SB06-752B-20	**SB06-751B-54RA	SB06-752A-43OS
	3/16"			

Part No.	Description
GB752BBK	Blind Bolt Kit 2 Nose Pieces (Straight only)
GB752BBK-1	Blind Bolt Kit 9 Nose Pieces (All listed above)

### BLIND RIVET KITS

- For installing blind rivets per NAS1919 S & U and NAS1921 S & U
- In an easy access carrying case with manuals and data sheets

GB751BRK Contents:

- Straight noses to install -4, -5 and -6
- Bleeder Bottle
- Pintail Catcher Bag
- Grip Selector Gage

GB751BRK-1 Contents:

- Additional right angle noses
- Offset noses
- Stroke limiter.

\* Noses listed protrude 2 Inches from the tool. Longer noses are available.

\*\* Required 751153 stroke limiter

For 4.5 Inches order SMLSxx-752B-45

For 8.0 Inches order SMLSxx-752B-80



Blind Rivet	Dia.	Nose Assembly		
		Straight	Right Angle	Offset
	1/8"	*SMLS04-752B-20	**SMLS04-751B-54RA	SMLS04-752A-43OS
	5/32"	*SMLS05-752B-20	**SMLS05-751B-54RA	SMLS05-752A-43OS
	3/16"	*SMLS06-752B-20	**SMLS06-751B-54RA	SMLS06-752A-43OS

Part No.	Description
GB751BRK	Blind Rivet Kit with 3 Nose Pieces (Straight only)
GB751BRK-1	Blind Rivet Kit with 9 Nose Pieces (All listed above)

### LOCKBOLT® RIVETING KIT

- For 5/32" thru 1/4" HUCK® (H)LGPL lockbolts.
- In an easy access carrying case with manuals and data sheets.

Contents:

- Set of straight noses to install -5, -6 and -8 Diameters
- Bleeder Bottle
- Grip Scale
- Pintail Catcher Bag



Rivet	Boing Rivet	Collar	Boeing Collar
LGPL2SC-V	BACB30VM	3SLC-C	BACC30BK
LGPL18SCV	BACB30XT	3SLC-C	BACC30BK
LGPL4SC-V	ABS0548	3SLC-C	ASNA2025
LGPL2SP-V	BACB30VN	3SLC-C	BACC30BK
LGPL4SP-V	ASNA2392	3SLC-C	ASNA2025
LGPL8SC-V	BACB30WD	SLFC-MV	BACC30BN
LGPL9SC-V	BACB30WB	SLFC-MV	BACC30BN
LGPL9SP-V	BACB30VY	SLFC-MV	BACC30BN

Part No.	Description
GB731LGPK	Rivet Kit for Huck® Lockbolts

### BLIND BOLT RIVETING KITS

- For installing Huck® and Cherry® blind bolts per MS21140 & MS21141 (U or S) and MS90353 & MS90354 (U or S)
- In an easy access carrying case with manuals and data sheets.

GB713BBK Contents:

- Straight Noses to install -5, -6 & -8 Diameters, Bleeder Bottle, Pintail Catcher Bag, Grip Selector Gage.

GB713BBK-1 Contents:

- Right Angle and Offset Noses, Adapter, Stroke Limiters

\* Noses listed protrude 2 Inches from the tool. Longer noses are available

\*\* Required 722140 stroke limiter

For 4.5 Inches order SBxx-752B-45

For 8.0 Inches order SBxx-752B-80

Blind Rivet	Dia.	Nose Assembly			Fastener Type
		Straight	Right Angle	Offset	
	5/32"	*SB05-752C-20	**SB05-751C-54RA	SB05-752A-43OS	MS90353S & U & MS90354S & U
	3/16"	*SB06-752B-20	**SB06-751B-54RA	SB06-204D-27OS	
	3/16"				MS21140S & U & MS21141S & U
	1/4"	SB08-713-20 (requires 105 PSI for alloy steel)	SB08-713A-58RA	SB08-204D-27OS (requires 105 PSI for alloy steel)	CR7000 Series
	1/4"				BACB30YY, YU & YT

Part No.	Description
GB714BBK	Blind Bolt Kit 3 Nosepieces (Straight only)
GB714BBK-1	Blind Bolt Kit 9 Nosepieces



### RIVETING KIT – NAS TENSION AND NAS SHEAR LOCKBOLTS®

- For 5/32" thru 1/4" NAS Tension and NAS Shear lockbolts
- In an easy access carrying case with manuals and data sheets

GB731NASK Contents:

- Straight Noses to install -5, -6 & -8 Diameters, Bleeder Bottle, Grip Scale Selector and Pintail Catcher Bag
- Nose pieces marked \*

GB731NASK-1 Contents:

- Adapter and Offset Noses
- Nosepieces marked both\* and \*\*. The nosepieces marked \*\* require adapter 751204 which is supplied in the kit.

Self-releasing nose assemblies are available for pull-in applications. These are not included in the kit.

Straight noses are available 4.8in long from gun. Order NASXX-XXX-45.

Blind Rivet	Dia.	Fastener Type	Nose Assy
	5/32"	NAS7005, NAS7015, NAS7025, NAS7035GPL3SC-V05, GPL3SP-V05, GPL3SC-DT05, GPL3SP-DT05, GPL3SC-EU05, GPL3SP-EU05, GPL8TC-V05, GPL8TP-V05, GPL8TC-DT05, GPL8TPDT05, GPL8TC-EU05, GPL8TP-EU05	*NASS05-731-20 **NASS05-352A-20 NASS05-204B-300S
	5/32"	NAS1465, NAS1475, NAS1525, NAS1535NAS6935, NAS6955, NAS6965	*NAST05-731-20 **NAST05-352A-20 NAST05-204B-300S
	5/32"	NAS2005, NAS2105, NAS2115, NAS2125	
	3/16"	GPL3SC-V06, GPL3SP-V06, GPL3SC-DT06, GPL3SP-DT06, GPL3SC-EU06, GPL3SP-EU06, GPL8TC-V06, GPL8TP-V06, GPL8TC-DT06, GPL8TP-DT06, GPL8TC-EU06, GPL8TP-EU06	
	3/16"	NAS1436, NAS1446, NAS2406, NAS2506, NAS7006, NAS7016, NAS7026, NAS7036	*NAS06-731-20 **NAS06-352B-20 NAS06-204B-300S
	3/16"	NAS1456, NAS1466, NAS1476, NAS1516, NAS1526, NAS5136, NAS6936, NAS6946, NAS6956, NAS6966	
	3/16"	NAS2006, NAS2106, NAS2116, NAS2126	
	1/4"	GPL3SC-V08, GPL3SP-V08, GPL3SC-DT08, GPL3SP-DT08, GPL3SC-EU08, GPL3SP-EU08, GPL8TC-V08, GPL8TP-V08, GPL8TC-DT08, GPL8TP-DT08, GPL8TC-EU08, GPL8TP-EU08	
	1/4"	NAS1438, NAS1448, NAS2408, NAS2508, NAS7008, NAS7018, NAS7028, NAS7038	*NAS08-731-20 **NAS08-352-20 NAS08-204B-300S
	1/4"	NAS1458, NAS1468, NAS1478, NAS1518, NAS1528, NAS6938, NAS6948, NAS6958, NAS6968	
	1/4"	NAS2008, NAS2108, NAS2118, NAS2128	

Part No.	Description
GB731NASK	Rivet Kit for Lockbolts with 4 Nose Pieces
GB731NASK-1	Rivet Kit for Lockbolts with 8 Nose Pieces





## GAGE BILT SELECTION CHART – BLIND RIVETS

All tools will install a variety of fasteners. Refer to the tool flyer or manual for a list of noses and fasteners that the tool will install.

Most pneudraulic tools are available with Pistol Grip (SH) and In-line (SR) Split-Systems and/or vacuum collection systems.

"-" indicates the tool will install that fastener, but is not the most cost effective solution.

"X" indicates the tool is not recommended for that fastener.

\*Recommended for High Production applications GB940 (Electric) or GB910 (Air) Power Unit required. Order (A) tool with Air Power Unit. I.e GB2480(A)

\*\*GB204 and GB205 hydraulic installation tools are recommended for offset and closed access applications

If you did not find what you were looking for, please call our sales team!

Rivets	Pneumatic Tools		Pneudraulic Tools					Hydraulic Tools				
	GB50	GB51	GB751	GB722	GB714	GB745	GB756	GB874	*GB2480	*GB2581	**GB204	**GB205
CHERRYMAX® HUCKMAX® ALLMAX® NAS9301 12	x	1/8"	1/8"-3/16"	1/4"	-	-	-	-	1/8"-1/4"	-	-	x
UNIMATIC® BLIND RIVET NAS1919S & U NAS1921S & U	x	1/8"	5/32"-3/16"	1/4"	-	-	-	x	1/8"-1/4"	-	-	x
UNIMATIC BLIND BOLT MAXIBOLT® MS21140/1 S & U MS90353/4 S & U	x	x	1/8"-5/32"	1/8"-3/16"	1/8"-1/4"	-	1/8"-3/8"	x	5/32"-1/4"	5/16"-3/8"	-	-
CHERRYLOCK® NAS1398/99 NAS1738/39	x	x	x	x	x	x	-	1/8"-1/4"	x	x	x	x
"A" CODE CHERRYLOCK "A" NAS1398A NAS1399A	x	3/32"-1/8"	5/32"-3/16"	1/4"	x	-	-	x	3/32"-1/4"	-	-	x
NUTPLATE	3/32"-1/8"	3/32"-1/8"	-	-	x	x	-	x	3/32"-1/8"	-	x	x
FASTACK® AF5055 AF5075 S149A020	3/32"-5/32"	3/32"-5/32"	x	x	x	x	x	x	x	x	x	x
GROUND STUD BACS53BIEA1/2	x	x	-8-10	-	-	-	-	x	-8-10	-	-	x
MBC® NAS1719 - 21	x	1/8"	1/8"-3/16"	-	-	-	-	x	1/8"-3/16"	-	-	x
ASP® 2 ASP ASP FF ASP F ASP LC	x	x	13/64"	21/64"	-	-	-	x	13/64"-21/64"	-	13/64"-21/64"	x
UAB™ EN6122 & UAB130 EU EN6127 & UAB6127 EU EN6128 & UAB100 EU EN6129 & UABP EU MAXIBOLT® PLUS	x	x	3/16"-5/32"	3/16"-1/4"	-	x	-	x	1/8"-1/4"	x	1/8"-1/4"	x

## GAGE BILT SELECTION CHART – LOCKBOLTS®

Rivets	Pneudraulic Tools				Hydraulic Tools			
	GB731	GB745	GB756	*GB2480	*GB2581	**GB204	**GB205	
LGPL®, Lightweight, Groove, Proportioned, Lockbolt	5/32"-1/4"	5/32"-5/16"	5/16"-3/8"	5/32"-1/4"	5/16"-3/8"	5/32"-1/4"	5/16"-3/8"	
GPL®, Groove, Proportioned, Lockbolt	5/32"-1/4"	5/32"-5/16"	5/16"-3/8"	5/32"-1/4"	5/16"-3/8"	5/32"-1/4"	5/16"-3/8"	
MLGPL®, Metric, Lightweight, Groove, Proportioned, Lockbolt	4-5mm	6-8mm	8-10mm	4-5mm	8-10mm	-4-6	-8-10	
MGPL®, Metric, Groove, Proportioned, Lockbolt	4-6mm	6-8mm	8-10mm	4-6mm	8-10mm	-4-6	-8-10	
NAS TENSION	5/32"-1/4"	1/4"-5/16"	5/16"-3/8"	5/32"-1/4"	5/16"-3/8"	5/32"-1/4"	5/16"-3/8"	
NAS SHEAR	5/32"-1/4"	1/4"-5/16"	5/16"-3/8"	5/32"-1/4"	5/16"-3/8"	5/32"-1/4"	5/16"-3/8"	

Tool #	NAS9301-NAS9312	NAS1919 S & U NAS1921 S & U	MS21140/41 S & U MS90353/54 S & U	NAS 1398 1399 1738 1739	NAS1398A NAS1399A	Nut Plate	AF5055 AF 5075 S149A020	Ground Stud	NAS 1719 1720 1721 MBC	2ASP ASPFF ASPPLC ASPLC
GB50	x	x	x	x	x	3/32"-1/8"	3/32"-5/32"	x	x	x
GB51	1/8"	1/8"	X	X	3/32"-1/8"	3/32"-1/8"	-	X	3/32"-1/8"	X
GB751D	-	5/32"-3/16"	5/32"	X	5/32"-3/16"	-	-	-8	5/32"-3/16"	13-64"
GB704F	5/32"-3/16"	-	-	X	-	-	-	-	-	-
GB713D	-	1/4"	1/4"	X	1/4"	-	-	-	1/4"	21-64"
GB745D	-	-	5/16"	X	-	X	-	-	1/4"	-
GB752F	1/4"	-	3/16"	-	-	-	-	-10	-	17/64"
GB784B	X	X	X	1/8"-1/4"	X	X	X	X	X	X
GB746	-	-	5/32"-1/4"	X	-	-	-	-	-	-
GB2480B	1/8"-1/4"	1/8"-1/4"	5/32"-1/4"	X	3/32"-1/4"	3/32"-1/8"	-	-8 & -10	3/32"-1/4"	13/64"-21/64"
GB4801B	-	-	5/16"-3/8"	X	-	-	-	-	-	-
**GB204	-	-	-	X	-	X	-	-	-	-
**GB205	X	X	-	X	X	X	X	X	X	X
**GB7XX	-	-	-	X	-	-	-	-	-	-
**GB5XX	X	X	-	X	X	X	X	X	X	X

LOCKBOLT® is a registered trademark of Acument Intellectual Properties.

# Hi-Lok® Tooling

## HI-LOK® HAND REMOVAL TOOLS – HI-LOK® & HI-LITE® COLLAR REMOVAL TOOLS

Slips easily over any threaded collar (Hi-Lok®, Hi-Lite®, and Eddie-Bolt®) and quickly unscrews without cutting or prying. Particularly useful for round or damaged collars, the REM Series prevents metal shavings, broken pieces, and damage to skins or to the adjacent structure.



Part No.	12° Offset Handle				
	Collar Dash	Dollar Ø	Width	Height	OAL
REM 100-56T	-5 & -6	.283 - .335	.56	.35	5.6"
REM 100-8T	-8	.407 - .422	.67	.35	6"
REM 100-10T	-10	.512 - .538	.79	.40	7"
REM 100-1012T	-10 & small -12	.512 - .538	.79	.40	7"
REM 100-12T	-12	.614 - .649	.90	.50	8"
REM 100-14T	-14	.707 - .775	1.165	.625	10"
REM 100-16T	-16	.809 - .880	1.260	.625	11"
REM 100-18T	-18	.861 - .935	1.365	.625	12"
REM 100-20T	-20	.985 - 1.005	1.435	.625	13"

Part No.	Straight Handle				
	Collar Dash	Dollar Ø	Width	Height	OAL
REM 100-56TS	-5 & -6	.283 - .335	.56	.35	5.6"
REM 100-8TS	-8	.407 - .422	.67	.35	6"
REM 100-10TS	-10	.512 - .538	.79	.40	7"
REM 100-1012TS	-10 & small -12	.512 - .538	.79	.40	7"
REM 100-12TS	-12	.614 - .649	.90	.50	8"
REM 100-14TS	-14	.707 - .775	1.165	.625	10"
REM 100-16TS	-16	.809 - .880	1.260	.625	11"
REM 100-18TS	-18	.861 - .935	1.365	.625	12"
REM 100-20TS	-20	.985 - 1.005	1.435	.625	13"

## EDDIE-BOLT® HAND REMOVAL TOOLS



Part No.	12° Offset Handle				
	Collar Dash	Fastener Ø	Width	Height	OAL
REM 100-56E	-5	5/32"	.42	.35	5.6"
REM 100-56ES	-6	3/16"	.42	.35	5.6"
REM 100-8E	-8	1/4"	.56	.35	5.6"
REM 100-10E	-10	5/16"	.67	.35	6"
REM 100-12E	-12	3/8"	.79	.40	7"

Part No.	Straight Handle				
	Collar Dash	Fastener Ø	Width	Height	OAL
REM 100-56ES	-5	5/32"	.42	.35	5.6"
REM 100-56ES	-6	3/16"	.42	.35	5.6"
REM 100-8ES	-8	1/4"	.56	.35	5.6"
REM 100-10ES	-10	5/16"	.67	.35	6"
REM 100-12ES	-12	3/8"	.79	.40	7"

## CLOSE QUARTER WRENCHES

The Close Quarter 12 Point Wrench Series allows easier fastening in tight access areas due to its extremely thin wall. Also known as Ratchet Wrenches Close Clearance, this ratchet wrench from Omega Technologies was developed for use in compact areas or space. The Close Quarter Ratchet Wrench is fashioned to attain a ratcheting action through limited relative movement between the handle and head portion of the tool. Close-clearance ratchet box wrenches have a thin-walled yet strong 12-point swivel head that ratchets at a 30° angle. Ideal for working between closely spaced fasteners and in confined areas. Handle ratchets to right or left – turn over to reverse ratcheting. Use for 6-point and 12-point fasteners.

Made of heat-treated forged steel with a black finish.



Part No.	Wrench Opening	OAL	Height	Width	Handle Diameter
OMCQ187D	3/16	4	3/16	5/16	7/16
OMCQ218D	7/32	4-1/8	7/32	5/16	7/16
OMCQ250D	1/4	4-1/4	7/32	3/8	7/16
OMCQ312D	5/16	5-3/8	5-16	7/16	1/2
OMCQ375D	3/8	6-1/8	1-1/32	9/16	5/8
OMCQ437D	7/16	6-3/8	3/8	5/8	1-1/16
OMCQ500D	1/2	6-5/8	1-1/16	3/4	1-1/16

HI-LOK®, HI-SHEAR®, HI-LITE® and EDDIE BOLT® are registered trademarks of the Hi-Shear and Fairchild Fasteners. JO-BOLT® & VISU-LOK® are the registered trademarks of Monogram Aerospace Fasteners. CHERRYMAX® is a registered trademark of Textron Fasteners.

## SAVI-SOCKET COLLAR REMOVAL TOOLS

Savi-Socket is the newest innovation for removing Hi-Lok®, Hi-Lite®, Eddie-Bolt®, and HUCK threaded collar systems. It is the first socket to utilize a conical/tapered shape with helical teeth to remove collars or bolts. This design firmly draws the socket onto the collar, gripping and removing it with minimal effort and wear on the tool, without jamming the collar into the socket. The socket cannot be used to install or tighten collars after the hex is broken off. Experienced users are capable of removing collars 5-8 times faster than with traditional systems. Manufactured in the USA of high-strength tool steel, the socket is then heat-treated for optimum durability and finished with a highly visible corrosion-resistant coating. It is suited for use on aluminum, steel, titanium, and all coated collars. As an anti-FOD measure, it incorporates a set screw for positive retention.

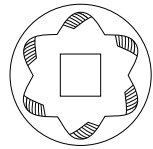

SAVI-59



12 Piece Set: SAVI-568-HL 1/4" Square Drive



6 Piece Set: SAVI-1012 3/8" Square Drive



4 Piece Set: SAVI-56810EB Eddie Bolt Sockets

Part No.	Nominal Collar Size	Collar "Dash" No.	Square Drive	Top of Collar (mm)	Top of Collar (in)	Eddie-Bolt® Hi-Lok® Hi-Lite®			
						SAVI-56810-EB	SAVI-568-HL	SAVI-568-RED	SAVI-1012
						Set 4 Pcs	Set 12 Pcs	Set 6 Pcs	Set 6 Pcs
SAVI-21	5/32"EB	5 EB	1/4"	5.5	0.21	21	-	-	-
SAVI-24	5/32, 3/16"EB	5 & 6 EB	1/4"	6.2	0.24	24	24	-	-
SAVI-25	5/32"	5	1/4"	6.5	0.25	-	25	25	-
SAVI-26	5/32 & 3/16	5, 6	1/4"	6.7	0.26	-	26	26	-
SAVI-27	5/32 & 3/16	5, 6	1/4"	7.0	0.27	-	27	-	-
SAVI-28	3/16"	6	1/4"	7.2	0.28	-	28	28	-
SAVI-29	3/16"	6	1/4"	7.5	0.29	-	29	29	-
SAVI-32	1/4", 1/4EB	8 & 8 EB	1/4"	8.2	0.32	32	32	-	-
SAVI-33	1/4"	8	1/4"	8.5	0.33	-	33	-	-
SAVI-34	1/4"	8	1/4"	8.7	0.34	-	34	-	-
SAVI-35	1/4"	8	1/4"	9.0	0.35	-	35	-	-
SAVI-36	1/4"	8	1/4"	9.2	0.36	-	36	36	-
SAVI-37	1/4"	8	1/4"	9.5	0.37	-	37	37	-
SAVI-39	5/16"EB	10 EB	1/4"	10.0	0.39	39	-	-	-
SAVI-43	5/16"	10	3/8"	11.0	0.43	-	-	-	43
SAVI-45	5/16"	10	3/8"	11.5	0.45	-	-	-	45
SAVI-47	5/16"	10	3/8"	12.0	0.47	-	-	-	-
SAVI-50	5/16"	10	3/8"	12.7	0.50	-	-	-	50
SAVI-51	3/8"	12	3/8"	13.0	0.51	-	-	-	51
SAVI-55	3/8"	12	3/8"	14.0	0.55	-	-	-	55
SAVI-56	3/8"	12	3/8"	14.3	0.56	-	-	-	56
SAVI-59	7/16"	14	3/8"	15.0	0.59	-	-	-	-
SAVI-63	7/16"	14	3/8"	16.0	0.63	-	-	-	-
SAVI-67	1/2"	16	1/2"	17.0	0.67	-	-	-	-
SAVI-69	1/2"	16	1/2"	17.5	0.69	-	-	-	-

## HI-LOK® COLLAR REMOVAL SOCKET

- Hi-Lok® style collars can be removed using this three prong socket and a hand or air ratchet
- The prongs grab into the Hi-Lok® collar allowing you to back it off like a nut

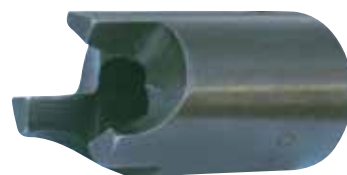

Part No.	Description	Pin Ø	Fastener Size	Drive Size
HS 1331-1	Hi-Lok® Removal Sockets	-5	5/32"	1/4"
HS 1331-2	Hi-Lok® Removal Sockets	-6	3/16"	1/4"
HS 1331-3	Hi-Lok® Removal Sockets	-8	1/4"	1/4"
HS 1332-1	Hi-Lok® Removal Sockets	-5	5/32"	3/8"
HS 1332-2	Hi-Lok® Removal Sockets	-6	3/16"	3/8"
HS 1332-3	Hi-Lok® Removal Sockets	-8	1/4"	3/8"

HI-LOK®, HI-SHEAR® are registered trademarks of the Hi-Shear and Fairchild Fasteners.

## OMAR SERIES COLLAR REMOVAL TOOL

The OMAR Series socket is a sure way to remove Hi-Lok®, Hi-Lite®, or similar aluminum collars. Its jaws ensure grip even on soft, damaged, or rounded collars. They are fully adjustable to any power hand tool with a reverse friction and a 3/8" drive. A hex key set screw is included as an anti-FOD measure.

- Powerful Grip
- Tailored to Specific Sizes
- Suited to soft or damaged collars

- \* Sleeveless
- \*\* Removes similar collar types



OMAR100-6



OMAR100-8



OMAR100-6

Hi-Lok® Part No.	Hi-Lite® Part No.	Dash Size	A Diameter (in)	C Diameter (in)
OMAR 100-5	OMAR 102-5	-5	5/8	11/16
OMAR 100-6	OMAR 102-6	-6	5/8	11/16
OMAR 100-8	OMAR 102-8	-8	7/8	3/4
OMAR 100-10	OMAR 102-10	-10	3/4*	3/4
OMAR 100-12	OMAR 102-12	-12	1**	1

## OMSK SERIES REMOVAL SOCKETS

The OMSK Series offers an efficient and convenient way to remove Hi-Lok® and Eddie-Bolt® collars. The patented 1/4" square drive collar removal sockets incorporate a tapered left-hand thread. When screwed counter-clockwise onto a collar, it draws it in until tight and unscrews the collar. This system is an excellent solution for steel and titanium as well as aluminum collars.

A hex key set screw is also included as an anti-FOD measure.

- Strong Grip
- Tailored to Sizes
- Replaces previous ATSK3581 Series sockets
- US Patent #5737981



OMSK3581-5/16

OMSK3581-1/4

OMSK Series

1/4" Part No.	3/8" Part No.	Dash Size	Collar Pin Dia.
OMSK3581-5/32	-	-5	5/32"
OMSK3581-3/16	-	-6	3/16"
OMSK3581-1/4	-	-8	1/4"
OMSK3581-5/16	OMSK3581A-5/16	-10	5/16"
OMSK3581-3/8	OMSK3581A-3/8	-12	3/8"
OMSK3581-7/16	OMSK3581A-7/16	-14	7/16"
	OMSK3581-1/2	-16	1/2"

## ANTI-FOD HEX SOCKETS

Anti-FOD Sockets are manufactured to fit conventional square drives. They feature a generous through-hole to enable the use of hex keys when necessary for Hi-Lok®, Hi-Lite®, and Hi-Tigue® installations. A set screw is provided to positively retain the sockets onto the square drives as an anti-FOD measure.



ATHS437

Part No.	Hex Opening (6-point)	Square Drive Size	Nose Diameter	OAL
ATHS156	5/32	1/4	0.280	0.86
ATHS187	3/16	1/4	0.312	0.86
ATHS218	7/32	1/4	0.312	0.86
ATHS250	1/4	1/4	0.375	0.88
ATHS281	9/32	1/4	0.410	0.88
ATHS312	5/16	1/4	0.467	0.88
ATHS343	11/32	1/4	0.508	0.88
ATHS375	3/8	3/8	0.560	1.00
ATHS375A	3/8	1/4	0.560	0.88
ATHS437	7/16	3/8	0.640	1.00
ATHS437A	7/16	1/4	0.600	0.86
ATHS500	1/2	3/8	0.710	1.00



## NORTHROP SIX-WING® TOOL

The Northrop version of the Six-Wing® tool incorporates a hex side for collar installation, and a spline side for removal. This arrangement also prevents the re-use of removed collars. Other sizes available on request



T201X37-2

Part No.	Collar Dash	OAL
T201X37-1	-1	5/32
T201X37-2	-2	3/16
T201X37-3	-3	1/4
T201X37-4	-4	5/16
T201X37-5	-5	3/8
T201X37-6	-6	7/16

## REM400 COLLAR REMOVAL TOOL

The Patented REM400 Collar Removal Tool is a refinement of the original REM300. Designed for rapid removal of collars from Threaded Pins, it is suited for use with Aluminum, Steel and Titanium Collars.

The unique cam-driven jaw closes automatically when operated in the counter-clockwise direction, quickly gripping collars and unscrewing them. The collars are retained in the jaws until the tool rotation is reversed (collars will not drop where they are not wanted). Simply switching the tool rotation to clock-wise, opens the jaws and allows the collar to fall freely.

US Patent # 6134992



REM400-56

Part No.	Description
REM400	Collar Removal Tool

## SIX-WING® COLLAR REMOVAL TOOL

The Six-Wing® frangible collar is characterized by its six-faceted, semi-spline arrangement of wings around the collar base. These collars are used in high strength applications typical of fighter aircraft. Special tapered spline sockets were developed to remove these collars. When fitted into the flat box-ratchet handle, these sockets provide easy removal, while at the same time preventing re-installation or re-use of the removed collars. New collars must be used to insure proper torque.

Available as an individual socket or a complete ratchet tool assembly

Splined type collar removal tool in standard or extended versions.

Other sizes available on request.



Socket Part No.	Complete Tool Part No.	Pin Ø	Pin Size (in)	OAL (L)	Socket Height (S)	Socket Ø (D)
CAT18-15	CAT19-15	-5	5/32	4.25	0.50	0.43
CAT18-18	CAT19-18	-6	3/16	4.25	0.50	0.43
CAT18-25	CAT19-25	-8	1/4	4.25	0.60	0.54
CAT18-31	CAT19-31	-10	5/16	5.50	0.70	0.67
CAT18-37	CAT19-37	-12	3/8	5.50	0.72	0.77
CAT18-43	CAT19-43	-14	7/16	5.50	0.80	0.92

Standard Socket



CAT18-31

Socket Part No.	Complete Tool Part No.	Pin Ø	Pin Size (in)	OAL (L)	Socket Height (S)	Socket Ø (D)
CAT18-15-1	CAT19-15-1	-5	5/32	4.25	1.00	0.43
CAT18-18-1	CAT19-18-1	-6	3/16	4.25	1.00	0.43
CAT18-25-1	CAT19-25-1	-8	1/4	4.25	1.00	0.54
CAT18-31-1	CAT19-31-1	-10	5/16	5.50	1.25	0.67
CAT18-37-1	CAT19-37-1	-12	3/8	5.50	1.25	0.77
CAT18-43-1	CAT19-43-1	-14	7/16	5.50	1.25	0.92

Extended Socket



CAT18-31-1

# Hi-Lok® Box Ratchets

Perfect for installing Hi-Lok® fasteners, these box ratchets are made of high quality, heat-treated steel and finished with a nickel-chrome plating. Small size and variable shape make the box ratchet ideal for use in tight areas. Even without line of sight, the head fits easily onto a collar, while the shoulder ring prevents the collar from slipping through the socket. An optional collar ejector pin quickly discards the removed collar.

Durable, Perfect for tight areas, shoulder ring inside socket, optional collar ejector pin, straight or offset 20°.

## FLAT BOX RATCHET WRENCHES WITH COLLAR STOP

- A ring inside hex socket positions the socket on the Hi-Lok® collar and prevents it dropping over collar.



Part No.	Hex 1	Hex 2	Radius 1	Radius 2	OAL
ATBR2125	7/32"	1/4"	19/64"	21/64"	4-1/2"
ATBR2528	1/4"	9/32"	19/64"	21/64"	4-1/2"
ATBR3134	5/16"	11/32"	19/64"	21/64"	4-1/2"
ATBR3137	5/16"	3/8"	25/64"	29/64"	5-1/2"
ATBR4350	7/16"	1/2"	25/64"	29/64"	5-1/2"

## FLAT BOX RATCHET WRENCHES WITH COLLAR STOP AND EJECTOR BUTTONS

Straight box ratchet positions the wrench on the Hi-Lok®. An ejector easily dislodges the hex portion of Hi-Lok®.



Part No.	Hex 1	Hex 2	Radius 1	Radius 2	OAL
ATBR2125E	7/32"	1/4"	19/64"	21/64"	4.09"
ATBR2528E	1/4"	9/32"	19/64"	21/64"	4.09"
ATBR3134E	5/16"	11/32"	19/64"	21/64"	4.09"
ATBR3137E	5/16"	3/8"	25/64"	29/64"	5.21"
ATBR4350E	7/16"	1/2"	25/64"	29/64"	5.21"

## OFFSET BOX RATCHET WRENCHES WITH COLLAR-STOP

- Offset box ratchet wrench has a ring inside the hex socket which positions the socket on the Hi-Lok® collar and prevents it dropping over collar.
- Offset 20°



Part No.	Hex 1	Hex 2	Radius 1	Radius 2	OAL
ATBRO2125	7/32"	1/4"	19/64"	21/64"	4.09"
ATBRO2528	1/4"	9/32"	19/64"	21/64"	4.09"
ATBRO3134	5/16"	11/32"	19/64"	21/64"	4.09"
ATBRO3137	5/16"	3/8"	25/64"	29/64"	5.21"
ATBRO4350	7/16"	1/2"	25/64"	29/64"	5.21"

## OFFSET BOX RATCHET WRENCHES WITH COLLAR-STOP AND EJECTOR BUTTONS

- Offset box ratchet positions the wrench on the Hi-Lok®. An ejector easily dislodges the hex portion of Hi-Lok®.
- Offset 20°



Part No.	Hex 1	Hex 2	Radius 1	Radius 2	OAL
ATBRO2125E	7/32"	1/4"	19/64"	21/64"	4.09"
ATBRO2528E	1/4"	9/32"	19/64"	21/64"	4.09"
ATBRO3134E	5/16"	11/32"	19/64"	21/64"	4.09"
ATBRO3137E	5/16"	3/8"	25/64"	29/64"	5.21"
ATBRO4350E	7/16"	1/2"	25/64"	29/64"	5.21"

HI-LOK®, EDDIE BOLT® & HI-LITE® are registered trademarks of the Hi-Shear and Fairchild Fasteners.

# Hi-Lok® Roller Ratchets®

Roller Ratchets® were developed in response to the need for very small ratchet wrenches for use in extremely tight areas where handle 'swing' was limited by obstructions, and by the need to have a ratchet that would engage with very little handle movement. The Roller Ratchet® satisfies both of these requirements, and this modular tool is now widely used in the aerospace community worldwide.

Continued research and development has improved the variety of tools available. With particular emphasis on strength, durability and quality whilst maintaining the functionality and cost-effectiveness of the entire line of tools.

The Roller Ratchet® functions as a hand ratchet, yet its size greatly increases its versatility by allowing it to be used in tighter areas. The incorporation of a special 'toothless' clutch eliminates all lost motion, allowing even the slightest movement to engage the tool. The modular platform allows for multiple configurations. A through-hole also makes the tool compatible with Hi-Lok®, Hi-Lite®, and Eddie Bolt® systems.

- Small design allows for use in tight areas
- Modular platform provides versatility
- Through-hole for use with Hi-Lok®, Hi-Lite®, and Eddie Bolt®
- Revolutionary clutch design
- Torque ratings from 150-600 lb-in.



## STANDARD ROLLER RATCHETS®

The standard Roller Ratchet® comes in a wide range of sizes and strengths. Its reversible spindle allows the tool to be used in any application for installation or removal.

- Roller Ratchet® with through-hole male 1/4" square Drive.
  - Compression ring for socket retention.
- \*Furnished with reversible spindle

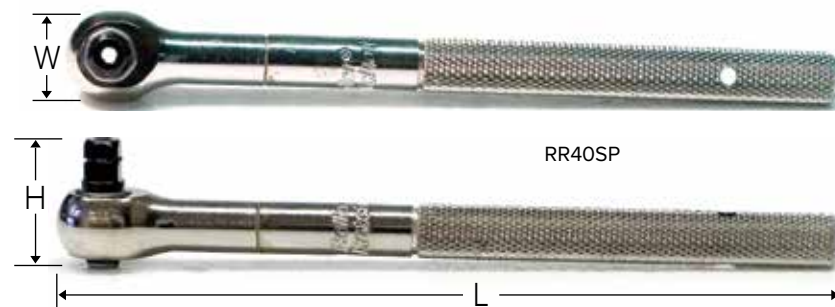

Part No.	Max Torque (lb/in)	Square Drive	Height (H)	Width (W)	Length (L)
RR40S-SP*	150	1/4	0.91	0.65	3.5
RR40SP*	150	1/4	0.91	0.65	5.5
RR80SP	200	1/4	1.37	0.60	6.25
RR130SP	250	1/4	0.92	0.87	7.2
RR250SP	400	3/8	1.21	1.00	7.9
RR400SP	600	3/8	1.21	1.31	8.7

## DOUBLE ENDED ROLLER RATCHETS®

The Double-Ended Roller Ratchet® eliminates the need to reverse the spindle from installation to removal, reducing the occurrence of foreign object damage.

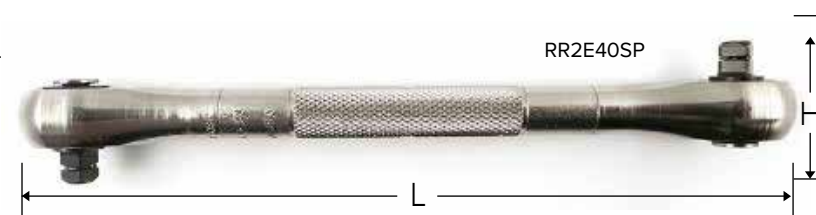

Part No.	Max Torque (lb/in)	Square Drive	Height (H)	Width (W)	Length (L)
RR2E40S-SP	150	1/4	0.91	0.65	4.5
RR2E40SP	150	1/4	0.91	0.65	6.5
RR2E80SP	200	1/4	1.37	0.60	6.7
RR2E130SP	250	1/4	0.92	0.87	6.6
RR2E250SP	400	3/8	1.21	1.00	8.9
RR2E400SP	600	3/8	1.21	1.31	8.9

HI-LOK® is a registered trademark of the Hi-Shear and Fairchild Fasteners. Roller Ratchet® is a registered Trademark of Omega Technologies, Inc

## LOW PROFILE ROLLER RATCHETS® WITH BUILT-IN SOCKET

The Integrated Socket Roller Ratchet® incorporates a low-profile shallow socket and comes in a wide range of sizes. Available fixed or reversible.

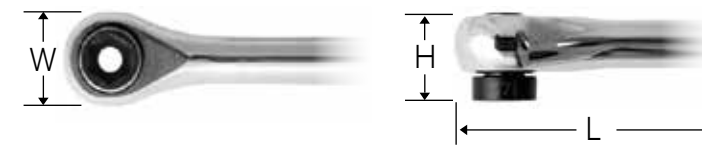

150 lb-in Max Torque H = .76 L = 3.5	150 lb-in Max Torque H = .76 L = 5.5	200 lb-in Max Torque H = 1.23 L = 6.25	250 lb-in Max Torque H = .78 & 1.01 L = 7.25	400 lb-in Max Torque H = 1.16 L = 7.9	Socket Hex Opening
RR40A18S-SP	RR40A18SP	-	-	-	3/16
RR40A21S-SP	RR40A21SP	-	-	-	7/32
RR40A25S-SP	RR40A25SP	RR80A25SP	RR130A25SP	-	1/4
RR40A28S-SP	RR40A28SP	RR80A28SP	RR130A28SP	-	9/32
RR40A31S-SP	RR40A31SP	RR80A31SP	RR130A31SP	-	5/16
RR40A34S-SP	RR40A34SP	RR80A34SP	RR130A34SP	-	11/32
RR40A37S-SP	RR40A37SP	-	RR130A37SP	-	3/8
RR40A43S-SP	RR40A43SP	-	RR130A43SP	-	7/16
-	-	-	-	RR250A50SP	1/2

## ROLLER RATCHETS® WITH STEPPED SOCKETS

The OMDD series Roller Ratchets® incorporate five integral sockets into a single wrench, allowing the installation of collar hex sizes 7/32, 1/4, 5/16, 11/32, and 3/8 inch. This one wrench covers most -5, -6, -8, -10, and -12 collars.

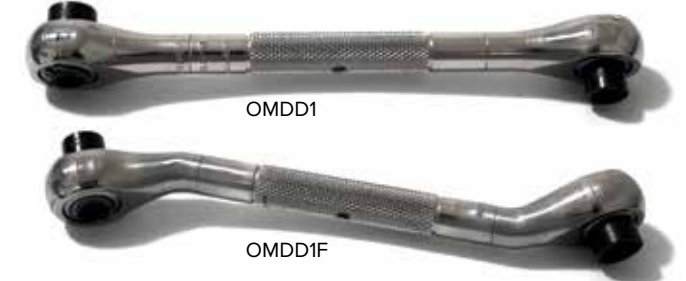

Part No.	Description	Version
OMDD1	Roller Ratchet® Stepped Socket	Straight
OMDD1F	Roller Ratchet® Stepped Socket	Offset

## ROLLER RATCHET® BIT HOLDER

The Bit Holder Roller Ratchet® is fitted with a 1/4" bit holder, making it compatible with any hex insert screwdriver bit.

The RRQC-BH1/4 quick change replacement for the 1/4" square drive spindle accommodates multiple insert bits.



Part No.	Description
RRQC-BH1/4	Roller Ratchet® Bit Holder

## ROLLER RATCHET® SPINDLE BIT HOLDER

The integrated spindle bit allows the wrench to accept the bit directly. The exclusion of the lengthier bit holder allows greater clearance, while still maintaining easy reversible capability. Phillips no. 1 included.



Part No.	Description
RR40A-P1	Roller Ratchet® Spindle Bit Holder

Roller Ratchet® is a registered Trademark of Omega Technologies, Inc



## HAND RATCHETS

Manufactured from high quality materials and nickel-plated for durability, these ratchets are available in a variety of sizes and are suitable for a wide range of installations, including Hi-Lok® systems.

This selection of hand ratchets provide a range of options to get the job done. A through-hole in the head of the ratchets make them compatible with Hi-Lok® systems. By increasing the number of teeth in the head (up to 72, depending on size), the ratchet engages with less movement. Finally, an ergonomic thumb switch changes the direction of the ratchet, allowing it to be used for installation or removal.

- Versatility of use
- Durable
- Easily reversible
- Compatible with Hi-Lok® system
- Engages with minimal movement



Part No.	Square Drive	Through Hole Ø	Head Width	Side to Center	Head Height	Overall Length	Weight (Lbs.)
ATHR-MINI	1/4"	0.11	0.92	0.46	0.40	4.60	0.20
ATHR250	1/4"	0.11	1.08	0.50	0.44	5.50	0.35
ATHR-TILT	1/4"	0.11	0.90	0.45	0.40	6.25	0.30
ATHR375	3/8"	0.21	1.40	0.70	0.60	7.85	0.85
ATHR500	1/2"	0.29	1.74	0.87	0.75	10.35	1.50

## HAND RATCHET "TIGHT SQUEEZE"

The Tight Squeeze is one of the newest innovations. It is a full function hand tool for Hi-Lok® and Hi-Lite® fasteners. The tool's unique profile allows for one-handed operation in tight spots, blind areas, and around corners. The operation is identical to pneumatic installation tools, but is more affordable and versatile.

Interchangeable hex keys and sockets fit an entire range of pin/collar combinations. The incorporated toothless ratcheting system from the Roller Ratchet® allows the slightest movement to engage the tool. This elegant solution turns impossible jobs into routine work.



TSQ25-312-079  
PATENT PENDING

Part No.	Socket Size	Socket Part No.	Hex Key Size	Hex Key Part No.
TSQ25-218-062	7/32	ATHS218	1/16	TSQ-062
TSQ25-250-062	1/4	ATHS250	1/16	TSQ-062
TSQ25-281-062	9/32	ATHS281	1/16	TSQ-062
TSQ25-312-062	5/16	ATHS312	1/16	TSQ-062
TSQ25-281-078	9/32	ATHS281	5/64	TSQ-078
TSQ25-312-078*	5/16	ATHS312	5/64	TSQ-078
TSQ25-343-078*	11/32	ATHS343	5/64	TSQ-078
TSQ25-437-078	7/16	ATHS437A	5/64	TSQ-078
TSQ25-312-094	5/16	ATHS312	3/32	TSQ-094
TSQ25-343-094	11/32	ATHS343	3/32	TSQ-094
TSQ25-437-094	7/16	ATHS437A	3/32	TSQ-094

HI-LOK® is a registered trademark of the Hi-Shear and Fairchild Fasteners.

\*Most popular

## 3 PIECE HI-LOK® ROLLER RATCHET® ASSEMBLY SET FOR SMALL COLLARS

Contents:

- Roller Ratchet®
- Anti-FOD Socket
- Hex-key



If you did not find what you were looking for, please call our sales team!

Part No.	Square Drive Size	Socket Hex Width	Hex Key Width	Hi-Shear Ref
ATRR1	1/4"	3/16" (.187)	1/16" (.062)	HLH110-187-062
ATRR2	1/4"	7/32" (.218)	1/16" (.062)	HLH110-218-062
ATRR3	1/4"	1/4" (.250)	1/16" (.062)	HLH110-250-062
ATRR4	1/4"	9/32" (.281)	1/16" (.062)	HLH110-281-062
ATRR5	1/4"	5/16" (.312)	1/16" (.062)	HLH110-312-062
ATRR6	1/4"	11/32" (.343)	1/16" (.062)	HLH110-343-062
ATRR7	1/4"	7/32" (.218)	5/64" (.078)	HLH110-218-078
ATRR8	1/4"	1/4" (.250)	5/64" (.078)	HLH110-250-078
ATRR9	1/4"	9/32" (.281)	5/64" (.078)	HLH110-281-078
ATRR10	1/4"	5/16" (.312)	5/64" (.078)	HLH110-312-078
ATRR11	1/4"	11/32" (.343)	5/64" (.078)	HLH110-343-078
ATRR12	1/4"	3/8" (.375)	5/64" (.078)	HLH110-375-078
ATRR13	1/4"	5/16" (.312)	3/32" (.094)	HLH110-312-094
ATRR14	1/4"	11/32" (.343)	3/32" (.094)	HLH110-343-094
ATRR15	1/4"	3/8" (.375)	3/32" (.094)	HLH110-375-094
ATRR16	3/8"	7/16" (.437)	3/32" (.094)	HLH110-437-094
ATRR21	3/8"	1/2" (.500)	3/32" (.094)	HLH110-500-094
ATRR17	3/8"	3/8" (.375)	1/8" (.125)	HLH110-375-125
ATRR18	3/8"	7/16" (.437)	1/8" (.125)	HLH110-437-125
ATRR22	3/8"	1/2" (.500)	1/8" (.125)	HLH110-500-125
ATRR19	3/8"	7/16" (.437)	5/32" (.156)	HLH110-437-156
ATRR20	3/8"	1/2" (.500)	5/32" (.156)	HLH110-500-156

## 2 PIECE HI-LOK® INTEGRAL SOCKET ASSEMBLY SET FOR SMALL COLLARS

Contents:

- Lowest profile integral socket Roller Ratchet®
- Hex-key



Part No.	Square Drive Size	Socket Hex Width	Hex Key Width	Hi-Shear Ref
RR40A187-062	1/4"	3/16" (.187)	1/16" (.062)	HLH110-187-062
RR40A218-062	1/4"	7/32" (.218)	1/16" (.062)	HLH110-218-062
RR40A250-062	1/4"	1/4" (.250)	1/16" (.062)	HLH110-250-062
RR40A281-062	1/4"	9/32" (.281)	1/16" (.062)	HLH110-281-062
RR40A312-062	1/4"	5/16" (.312)	1/16" (.062)	HLH110-312-062
RR40A343-062	1/4"	11/32" (.343)	1/16" (.062)	HLH110-343-062
RR40A218-078	1/4"	7/32" (.218)	5/64" (.078)	HLH110-218-078
RR40A250-078	1/4"	1/4" (.250)	5/64" (.078)	HLH110-250-078
RR40A281-078	1/4"	9/32" (.281)	5/64" (.078)	HLH110-281-078
RR40A312-078	1/4"	5/16" (.312)	5/64" (.078)	HLH110-312-078
RR40A343-078	1/4"	11/32" (.343)	5/64" (.078)	HLH110-343-078
RR40A375-078	1/4"	3/8" (.375)	5/64" (.078)	HLH110-375-078
RR130A312-094	1/4"	5/16" (.312)	3/32" (.094)	HLH110-312-094
RR130A343-094	1/4"	11/32" (.343)	3/32" (.094)	HLH110-343-094
RR130A375-094	1/4"	3/8" (.375)	3/32" (.094)	HLH110-375-094
RR130A437-094	3/8"	7/16" (.437)	3/32" (.094)	HLH110-437-094
RR250A500-094	3/8"	1/2" (.500)	3/32" (.094)	HLH110-500-094
RR130A375-125	3/8"	3/8" (.375)	1/8" (.125)	HLH110-375-125
RR130A437-125	3/8"	7/16" (.437)	1/8" (.125)	HLH110-437-125
RR250A500-125	3/8"	1/2" (.500)	1/8" (.125)	HLH110-500-125
RR130A437-156	3/8"	7/16" (.437)	5/32" (.156)	HLH110-437-156
RR250A500-156	3/8"	1/2" (.500)	5/32" (.156)	HLH110-500-156

HI-LOK®, HI-LITE® & EDDIE-BOLT® are the registered trademarks of the Hi-Shear and Fairchild Fasteners. ROLLER RATCHET® is the registered trademark of Omega Technologies Inc

### 3 PIECE HI-LOK® STANDARD RATCHET ASSEMBLY SET FOR SMALL COLLARS

- Hand tool assembly for the installation of the Hi-Lok® or Hi-Lite® fastening systems. The ATHA Series consists of a hand ratchet wrench (ATHR250) with a through hole, a socket, and a plastic handle Allen® wrench.
- The through hole in the ratchet allows for the insertion of an Allen® key. While any Allen® key style may be used in conjunction with the ratchet, a plastic handle or a "T" handle Allen® wrench with a replaceable blade is furnished. The socket is held to the square drive with a set screw, eliminating FOD.
- This entire assembly is completely interchangeable with the Hi-Shear equivalent

#### Contents:

- Standard Ratchet
- Anti-FOD Socket
- Hex-key



Part No.	Square Drive Size	Socket Hex Width	Hex Key Width	Hi-Shear Ref
ATHA1	1/4"	3/16" (.187)	1/16" (.062)	HLH110-187-062
ATHA2	1/4"	7/32" (.218)	1/16" (.062)	HLH110-218-062
ATHA3	1/4"	1/4" (.250)	1/16" (.062)	HLH110-250-062
ATHA4	1/4"	9/32" (.281)	1/16" (.062)	HLH110-281-062
ATHA5	1/4"	5/16" (.312)	1/16" (.062)	HLH110-312-062
ATHA6	1/4"	11/32" (.343)	1/16" (.062)	HLH110-343-062
ATHA7	1/4"	7/32" (.218)	5/64" (.078)	HLH110-218-078
ATHA8	1/4"	1/4" (.250)	5/64" (.078)	HLH110-250-078
ATHA9	1/4"	9/32" (.281)	5/64" (.078)	HLH110-281-078
ATHA10	1/4"	5/16" (.312)	5/64" (.078)	HLH110-312-078
ATHA11	1/4"	11/32" (.343)	5/64" (.078)	HLH110-343-078
ATHA12	1/4"	3/8" (.375)	5/64" (.078)	HLH110-375-078
ATHA13	1/4"	5/16" (.312)	3/32" (.094)	HLH110-312-094
ATHA14	1/4"	11/32" (.343)	3/32" (.094)	HLH110-343-094
ATHA15	1/4"	3/8" (.375)	3/32" (.094)	HLH110-375-094
ATHA16	3/8"	7/16" (.437)	3/32" (.094)	HLH110-437-094
ATHA21	3/8"	1/2" (.500)	3/32" (.094)	HLH110-500-094
ATHA17	3/8"	3/8" (.375)	1/8" (.125)	HLH110-375-125
ATHA18	3/8"	7/16" (.437)	1/8" (.125)	HLH110-437-125
ATHA22	3/8"	1/2" (.500)	1/8" (.125)	HLH110-500-125
ATHA19	3/8"	7/16" (.437)	5/32" (.156)	HLH110-437-156
ATHA20	3/8"	1/2" (.500)	5/32" (.156)	HLH110-500-156

### THROUGH-HOLE 1/4" DRIVE EXTENSIONS

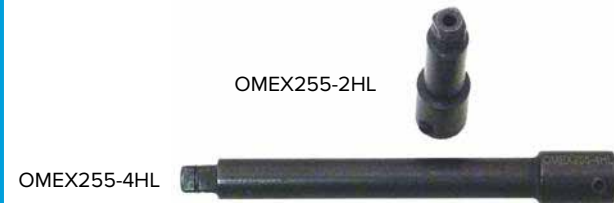

Part No.	Description	Length
OMEX255-2HL	Through Hole Extension	2 in
OMEX255-4HL	Through Hole Extension	4 in

### REPLACEMENT TIPS – HI-SHEAR® SUPER KEY



Part No.	Description	Hex Key Size
HLT140K062	Repl. Tip Hi-Shear Super Key	1/16 / 0.062
HLT140K078	Repl. Tip Hi-Shear Super Key	5/64 / 0.079
HLT140K094	Repl. Tip Hi-Shear Super Key	3/32 / 0.094
HLT140K125	Repl. Tip Hi-Shear Super Key	1/8 / 0.125
HLT140K156	Repl. Tip Hi-Shear Super Key	5/32 / 0.156
HLT140K187	Repl. Tip Hi-Shear Super Key	3/16 / 0.187

### HAND-HELD HEX KEYS – PLASTIC HANDLE



Part No.	Description	Hex Key Size
ATHK062	Hand-held Hex Key	1/16 / 0.062
ATHK079	Hand-held Hex Key	5/64 / 0.079
ATHK094	Hand-held Hex Key	3/32 / 0.094
ATHK125	Hand-held Hex Key	1/8 / 0.125

### REPLACEMENT TIPS – HI-SHEAR® STANDARD



Part No.	Description	Hex Key Size
HLT140-062	Replacement Tip Hi-Shear®	1/16 / 0.062
HLT140-078	Replacement Tip Hi-Shear®	5/64 / 0.079
HLT140-094	Replacement Tip Hi-Shear®	3/32 / 0.094
HLT140-125	Replacement Tip Hi-Shear®	1/8 / 0.125
HLT140-156	Replacement Tip Hi-Shear®	5/32 / 0.156
HLT140-187	Replacement Tip Hi-Shear®	3/16 / 0.187

HI-LOK®, HI-LITE® & EDDIE-BOLT® are the registered trademarks of the Hi-Shear and Fairchild Fasteners.

### REPLACEMENT TIPS – LOK-FAST® QRS®



Part No.	Description	Hex Key Size
QRK5	Replacement Tip Lok-Fast® QRS®	1/16 / 0.062
QRK6	Replacement Tip Lok-Fast® QRS®	5/64 / 0.079
QRK8	Replacement Tip Lok-Fast® QRS®	3/32 / 0.094
QRK10	Replacement Tip Lok-Fast® QRS®	1/8 / 0.125
QRK12	Replacement Tip Lok-Fast® QRS®	5/32 / 0.156

### REPLACEMENT TIPS – VOI-SHAN KWIK-KEY®



Part No.	Description	Hex Key Size
KK101-06	Repl. Tip Voi-Shan KWIK-Key®	1/16 / 0.062
KK101-07	Repl. Tip Voi-Shan KWIK-Key®	5/64 / 0.079
KK101-09	Repl. Tip Voi-Shan KWIK-Key®	3/32 / 0.094

### 13 PIECE "LIBERATOR" RATCHET SET FOR HI LOK® INSTALLATION

- The Liberator system enables easy installation of frangible collar type fasteners in the most awkward and unusual situations
- The ratchet heads feature the unique ability to be "indexed" in position within 360° making this system extremely flexible

#### Contents:

- 2 x toothless "roller clutch" ratchet heads
- 2 x 1/4" Drive studs (fit any standard 1/4" Drive socket)
- Variety of straight and 90° handles



Part No.	Description
LIBK-13	13 Piece "Liberator" Ratchet Set



### 8 PIECE ROLLER RATCHET® SET

#### Contents:

- 2 x 1/4" square Drive reversible Roller Ratchets®
- Hi-Lok® Collar Removal Plier
- 6 Integral Socket, Hi-Lok® Installation Roller Ratchets®
- Rugged Case



Part No.	Description
RRSKT8	8 Piece Roller Ratchet® Set

HI-LOK® is a registered trademark of the Hi-Shear and Fairchild Fasteners. Roller Ratchet® is a registered Trademark of Omega Technologies, Inc



## HAND INSTALLATION & REMOVAL KIT

- ATHR250 1/4" Sq Dr. Reversible Hand Ratchet, 72 Teeth, (5 degree arc between clicks) with Through Hole
- OMSK3581-5, OM3581-6, OM3581-8, OM3581-10 Hi-Lok® collar Removal Sockets for Dash 5, 6, 8, 10 Size Collars
- 9 Anti-FOD Sockets with set screws ( 5/32, 3/16, 7/32, 1/4, 9/32, 5/16, 11/32, 3/8, 7/16 )
- 3 Handi-Hex Hex Keys with replaceable blades for all 5/32", 3/16", 1/4" (-5, -6, -8) Hi-Lok® Pins
- Rugged Case



Part No.	Description
OMHLKT1000	Hand Installation & Removal Kit

## PNEUMATIC INSTALLATION & REMOVAL KIT

- AR250 1/4" Sq Dr. Reversible AIR- Ratchet, with Through Hole for Hex Keys
- OMSK3581-5, OM3581-6, OM3581-8, OM3581-10 Hi-Lok® collar Removal Sockets for Dash 5, 6, 8, 10 Size Collars
- 9 X Anti-FOD Sockets with set screws ( 5/32, 3/16, 7/32, 1/4, 9/32, 5/16, 11/32, 3/8, 7/16 )
- 3 X Handi-Hex Hex Keys with replaceable blades for all 5/32", 3/16", 1/4" (-5, -6, -8) Hi-Lok Pins
- Rugged Case



Part No.	Description
OMHLKT2000	Pneumatic Installation & Removal Kit

## STAHLWILLE 1/4" DRIVE 9 PIECE HI-LOK SOCKET SET 4008/271R

German precision quality socket set in sturdy, stackable ABS plastic case

Contents:

- 5 sockets 12 point No 40aD: 7/32; 1/4; 5/16; 11/32; 3/8"
- 3 offset screwdrivers No 10759a: 1/16; 5/64; 3/32"
- 1 ratchet No 415SGH N



Part No.	Description	Weight (g)
96 01 63 03	9 Piece Hi-Lok Socket Set Imperial	556

HI-LOK® is a registered trademark of the Hi-Shear and Fairchild Fasteners.

## HI-LOK® PIN PROTRUSION GAUGE SETS

Manufactured for use on all types of frangible and torque-control fasteners. These gauges determine if the correct length pin has been installed by determining if the pin's protrusion is between the allowable minimum and maximum limits shown on the gauge.



Dash Sizes	Nominal Pin Diameter		2-1522 Pin Protrusion Limits*		2-1522-B Pin Protrusion Limits**		2-1522 HST Pin Protrusion Limits*		2-1522 HST-B Pin Protrusion Limits**		
	Decimal	Fraction	Decimal	Min	Max	Min	Max	Min	Max	Min	Max
-5		5/32"	0.1560	0.302	0.384	0.302	0.389	0.270	0.352	0.270	0.352
-6		3/16"	0.1875	0.315	0.397	0.315	0.402	0.280	0.362	0.280	0.362
-8		1/4"	0.2500	0.385	0.467	0.385	0.472	0.310	0.392	0.310	0.392
-10		5/16"	0.3125	0.490	0.572	0.490	0.577	0.370	0.452	0.370	0.452
-12		3/8"	0.3750	0.535	0.617	0.535	0.622	0.410	0.492	0.410	0.492

Dash Sizes	Nominal Pin Diameter		2-1522-2 Pin Protrusion Limits*		2-1522-B-2 Pin Protrusion Limits**		2-1522 HST-2 Pin Protrusion Limits*		2-1522 HST-B-2 Pin Protrusion Limits**		
	Decimal	Fraction	Decimal	Min	Max	Min	Max	Min	Max	Min	Max
-14		7/16"	0.4375	0.625	0.707	0.625	0.707	0.475	0.557	0.475	0.557
-16		1/2"	0.5000	0.675	0.757	0.675	0.757	0.515	0.597	0.515	0.597
-18		9/16"	0.5625	0.760	0.842	0.760	0.842	0.590	0.672	0.590	0.672
-20		5/8"	0.6250	0.815	0.897	0.815	0.897	0.650	0.732	0.630	0.712
-24		3/4"	0.750	1.040	1.122	1.040	1.122				

HST = red print colour

## HI-SHEAR® GRIP GAGE

- Thicker side is used to measure the "grip-length" of Hi-Lok® and Hi-Lite® pins, Shear Lockbolts, structural screws, and bolts.
- Thinner side is used to measure the thickness of materials to be fastened, so choose the proper length pin.



Part No.	Description
CATGS1	Hi-Shear® Grip Gage

## HI-SHEAR® GRIP GAGE SLIDE & ASSEMBLY



Part No.	Description
2-612	Hi-Shear® Grip Gage
2-615	Hi-Shear® Grip Gage Slide
2-651	Hi-Shear® Grip Gage and Slide Assembly

## JO-BOLT® GRIP GAGE



Part No.	Description
LFVLG-1	Jo-Bolt® Grip Gage (Visu-Lok)

## CHERRYMAX® GRIP GAGE



Part No.	Description
269C3	CherryMax® Grip Gage

## HOLLOW CUTTER 1/4-28 – HI-SHEAR® OR HI-LOK® COLLARS

These tools are designed to cut away swaged or threaded collars from fasteners so the fastener pin can be easily removed. They are ideal for removing Hi-Shear® rivets.

The rotating cutter is applied to the collar until a sufficient amount of collar material has been removed. The pin is then easily removed with a punch. A microstop cage is typically used to prevent the cutter teeth from contacting and damaging the work surface.

Four flute design for strength and increased tool life



Larger sizes available on request

Part No.	Description	Body Ø (B)	Hole Ø (H)	Fastener Size
HC19018	Hollow Cutter 1/4-28	0.365	5/32"	1/4"
HC19532	Hollow Cutter 1/4-28	0.365	3/16"	1/4"
HC19316	Hollow Cutter 1/4-28	0.438	1/4"	1/4"
HC19014	Hollow Cutter 1/4-28	0.500	5/32"	3/8"
HC19516	Hollow Cutter 1/4-28	0.562	3/16"	3/8"

HI-LOK® and HI-LITE® are registered trademarks of the Hi-Shear and Fairchild Fasteners.

### SPEED DRIVER HAND RIVNUT GUN

Rapid manual installation of Rivnuts, steel or aluminium



Part No.	Description	Thread Size
RN 6440	Speed Driver Rivnut Tool	4-40
RN 6632	Speed Driver Rivnut Tool	6-32
RN 6832	Speed Driver Rivnut Tool	8-32
RN 6103	Speed Driver Rivnut Tool	10-32
RN 6142	Speed Driver Rivnut Tool	1/4-28

### REPLACEMENT MANDRELS – ECONOMY RIVNUT TOOL



Part No.	Description	Thread Size
RM 4440	Replacement Mandrel	4-40
RM 4632	Replacement Mandrel	6-32
RM 4832	Replacement Mandrel	8-32
RM 4103	Replacement Mandrel	10-32
RM 4142	Replacement Mandrel	1/4-28

### CAMLOC PLIER

Camloc plier designed for stud series 2600, 2700 and 4002



Part No.	Description
PC 0443	Camloc Plier

### SIDE GRIP CLAMP HOLDER



Part No.	Description
GCH030	Side Grip Clamp Holder

### TEMPORARY FASTENER HOLDER

for 25 fasteners



Part No.	Description	Size
TFH025332	Temporary Fastener Holder	3/32
TFH025018	Temporary Fastener Holder	1/8
TFH025532	Temporary Fastener Holder	5/32
TFH025316	Temporary Fastener Holder	3/16
TFH025014	Temporary Fastener Holder	1/4
TFH025516	Temporary Fastener Holder	5/16

### REPLACEMENT MANDRELS – SPEEDRIVER RIVNUT TOOL



Part No.	Description	Thread Size
RM 6440	Replacement Mandrel	4-40
RM 6632	Replacement Mandrel	6-32
RM 6832	Replacement Mandrel	8-32
RM 6103	Replacement Mandrel	10-32
RM 6142	Replacement Mandrel	1/4-28

### ECONOMY RIVNUT TOOL

Low cost method of installing Rivnuts – steel or aluminium



Part No.	Description	Thread Size
RN 4440	Economy Rivnut Tool	4-40
RN 4632	Economy Rivnut Tool	6-32
RN 4832	Economy Rivnut Tool	8-32
RN 4103	Economy Rivnut Tool	10-32
RN 4142	Economy Rivnut Tool	1/4-28

### SILOUX™ RIVNUT GUN – PNEUMATIC

- Wrenchless head assembly makes it easy to change the size or style without the use of tools
- Grease fitting on the nose assembly allows lubrication to the thrust bearing for reduced wear and longer life
- Large thrust bearing for improved bearing life
- 3/4 in (20 mm) nose diameter for easy access into tight spaces



Part No.	Description	RPM	Thread Size
SCN12R632S	Sioux Rivnut Gun	1200	6-32
SCN12R832S	Sioux Rivnut Gun	1200	8-32
SCN12R1032S	Sioux Rivnut Gun	1200	10-32

### CAMLOC SNAP RING TOOL

Use this tool to easily and quickly install snap rings on the back side of all Camloc 4002 series grommets



Part No.	Description
MS-T26	Camloc Snap Ring Tool

### CLECO HOLDER

for 25 fasteners



Part No.	Description	Size
HCH025116	Cleco Holder	1/16
HCH025332	Cleco Holder	3/32
HCH025018	Cleco Holder	1/8
HCH025532	Cleco Holder	5/32
HCH025316	Cleco Holder	3/16
HCH025732	Cleco Holder	7/32
HCH025014	Cleco Holder	1/4

### HI-LOK® PLIERS

- This variation of the ATI® model is equipped with a hardened, diamond-jaw pattern that allows the pliers to grip aluminum collars from any direction.
- Fasteners can be gripped at nearly every angle
- Special hardened steel jaws with diamond cut pattern for good grip



Part No.	Description
ZHP100	Hi-Lok Pliers

### HI-LOK® PLIERS

More aggressive offset of about 60°. The jaw serrations are perpendicular to the collar seating surface when the handles are laid flat, but angle at 3 degrees if the flat part of the head is rested on the collar seating surface.



Part No.	Description
CRP2979	Hi-Lok® Pliers

### SPRING TENSION CLAMP PLIER OPERATED STEEL

Provides 32kg clamping pressure



Part No.	Description	Reach
SC552	Tension Clamp	2"
SC553	Tension Clamp	3"

### CLECO PLIERS

- Used for the installation of MM, M, ML, MHD type fasteners
- Compatible with all types of spring loaded fasteners



Part No.	Description
MP 0463	Cleco® Plier with Vinyl Grips on handles

### COLLAR CLAW® COLLAR REMOVAL TOOL

- Fun, fast, low-fatigue and durable.
- Works on stripped bolt heads, rounded nuts, threaded studs and a host of other fasteners.
- For Use with any threaded collar: Hi-Lite, Hi-Lok: -5, -6, -8 Eddie Bolt: -5, -6, -8, -10 Threaded Huck: -5, -6, -8.



Part No.	Description
CRP568	Collar Claw® Collar Removal Tool

### CHERRY® FLUSH NIPPER

Flush cutting plier for trimming Cherry® rivets



Part No.	Description
PC 0457	Cherry® Nipper

### RIVET CUTTER HEAVY DUTY

- Allows aluminium rivets to be cut from 1/16" to 1/4" diameter.
- Rivets can be cut to the same length each time using the leaf spacers



Part No.	Description
RC 1002	Heavy Duty Rivet Cutter

### SPRING TENSION CLAMP PLIER OPERATED ZINC

Provides 32kg clamping pressure



Part No.	Description	Capacity	Reach
SC542	Tension Clamp	11mm	50mm



# Temporary Fasteners

A complete line of solutions for temporary fixturing and joining of panels, components and structures. For accurate clamping in structural or thin sheet metal applications and also composite material stack ups. Our range includes pneumatic, battery powered motors for fast installation and some specialized hand tools.

## SPRING CLECO® – 'M' STANDARD BODY

- Colour coded for easy identification
- Plier operated, spring loaded fasteners
- Standard button plunger fasteners for precise holding of sheets



Part No.	Capacity	Drill Size	Colour
M 1/16	0 - 1/4"	1/16"	Black
M 3/32	0 - 1/4"	#40 (3/32)	Zinc
M 1/8	0 - 1/4"	#30(1/8)	Copper
M 5/32	0 - 1/4"	#21 (5/32)	Black
M 3/16	0 - 1/4"	#10 (3/16)	Brass
M 7/32	0 - 7/32"	#2 (7/32)	Zinc
M 1/4	0 - 5/16"	1/4"	Copper

## SPRING CLECO® – 'MM' MINATURE BODY



Part No.	Capacity	Drill Size	Colour
MM 3/32	0 - 1/4"	#40	Zinc
MM 1/8	0 - 1/4"	#30	Copper
MM 5/32	0 - 1/4"	#20	Black
MM 3/16	0 - 1/4"	#10	Brass

## SPRING CLECO® – 'MHD' HEAVY DUTY BODY



Part No.	Capacity	Drill Size	Colour
MHD 3/32	0 - 1/2"	#40	Zinc
MHD 1/8	0 - 1/2"	#30	Copper
MHD 5/32	0 - 1/2"	#20	Black
MHD 3/16	0 - 1/2"	#10	Brass
MHD 7/32	0 - 7/32"	#2	Zinc
MHD 1/4	0 - 1/2"	1/4"	Copper

## SPRING CLECO® – 'ML' LONG GRIP



Part No.	Capacity	Drill Size	Colour
ML 3/32	1/4 - 1/2"	#40	Zinc
ML 1/8	1/4 - 1/2"	#30	Copper
ML 5/32	1/4 - 1/2"	#20	Black
ML 3/16	1/4 - 1/2"	#10	Brass

## PNEUMATIC CLECO TOOL

- Quick installation or removal of spring type Cleco's
- Supplied with 1.5m hose



Part No.	Description
PCT-109	Pneumatic Cleco Tool

## SPRING CLECO® NO-MAR CAPS

Easily slips over cleco to prevent damage to aircraft skin.



Part No.	Description	Size	Colour
KSCAP-3/32	Spring Cleco No-Mar Caps	3/32"	Grey
KSCAP-1/8	Spring Cleco No-Mar Caps	1/8"	Orange
KSCAP-5/32	Spring Cleco No-Mar Caps	5/32"	Black
KSCAP-3/16	Spring Cleco No-Mar Caps	3/16"	Blue
KSCAP-1/4	Spring Cleco No-Mar Caps	1/4"	Yellow

## 'EL' TYPE SIDE GRIP CLAMPS

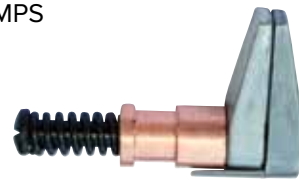

Part No.	Capacity	Drill Size	Colour
EL 1/2-1/2	0 - 1/2"	1/2"	Copper
EL 3/4-1/2	0 - 3/4"	1/2"	Brass
EL 1/2-1	0 - 1/2"	1"	Copper
EL 3/4-1	0 - 3/4"	1"	Brass

See our Cleco holders and Side Grip Holders on Page 234

## HEX BODY TEMPORARY FASTENERS

The Hex-Nut temporary fastener series is designed to be operated with a pneumatic power tool and suited to high-production applications, providing consistent and high clamping force. Its 'Spin-Free' design allows nut to back completely off while still remaining intact with the body. This series fastener is suitable for use with all types of metallic and composite materials.



Part No.	Cross Ref.	Grip Range	Drill Size	Colour
KHNS-FW-3/32	HNXS-SF-3/32	0 - 5/16"	#40	Zinc
KHNS-FW-1/8	HNXS-SF-1/8	0 - 5/16"	#30	Copper
KHNS-FW-5/32	HNXS-SF-5/32	0 - 5/16"	#20	Black
KHNS-FW-3/16	HNXS-SF-3/16	0 - 5/16"	#10	Brass
KHNS-FW-1/4	HNXS-SF-1/4	0 - 5/16"	F	Copper
KHN-FW-3/32	HNX-SF-3/32	0 - 1/2"	#40	Zinc
KHN-FW-1/8	HNX-SF-1/8	0 - 1/2"	#30	Copper
KHN-FW-5/32	HNX-SF-5/32	0 - 1/2"	#20	Black
KHN-FW-3/16	HNX-SF-3/16	0 - 1/2"	#10	Brass
KHN-FW-7/32	HNX-SF-7/32	0 - 1/2"	#2	Zinc
KHN-FW-1/4	HNX-SF-1/4	0 - 1/2"	F	Copper
KHN-FW-5/16	HNX-SF-5/16	0 - 1/2"	O	Black
KHNL-FW-3/32	HNXL-SF-3/32	0 - 1"	#40	Zinc
KHNL-FW-1/8	HNXL-SF-1/8	0 - 1"	#30	Copper
KHNL-FW-5/32	HNXL-SF-5/32	0 - 1"	#20	Black
KHNL-FW-3/16	HNXL-SF-3/16	0 - 1"	#10	Brass
KHNL-FW-7/32	HNXL-SF-7/32	0 - 1"	#2	Zinc
KHNL-FW-1/4	HNXL-SF-1/4	0 - 1"	F	Copper
KHNL-FW-5/16	HNXL-SF-5/16	0 - 1"	O	Black
KHNK-FW-1/8	HNXK-SF-1/8	1.5 - 2.5"	#30	Copper
KHNK-FW-5/32	HNXK-SF-5/32	1.5 - 2.5"	#20	Black
KHNK-FW-3/16	HNXK-SF-3/16	1.5 - 2.5"	#10	Brass
KHNK-FW-1/4	HNXK-SF-1/4	1.5 - 2.5"	F	Copper
KHNK-FW-5/16	HNXK-SF-5/16	1.5 - 2.5"	O	Black
KHNEL-FW-3/32	HNXEL-SF-3/32	1/2 - 1.5"	#40	Zinc
KHNEL-FW-1/8	HNXEL-SF-1/8	1/2 - 1.5"	#30	Copper
KHNEL-FW-5/32	HNXEL-SF-5/32	1/2 - 1.5"	#20	Black
KHNEL-FW-3/16	HNXEL-SF-3/16	1/2 - 1.5"	#10	Brass
KHNEL-FW-7/32	HNXEL-SF-7/32	1/2 - 1.5"	#2	Zinc
KHNEL-FW-1/4	HNXEL-SF-1/4	1/2 - 1.5"	F	Copper
KHNEL-FW-5/16	HNXEL-SF-5/16	1/2 - 1.5"	O	Black

## SIoux™ HEX BODY TEMPORARY FASTENER RUNNER

- Designed for the installation of all HNX/HNXL and HNXEL Hex Body Temporary Fasteners (skin pins).
- Pistol grip with rapid reverse.



Part No.	RPM (no load)	Torque	OAL
SSR6P-25	2,500	55 in-lbs	235mm

SIoux™ is a registered trademark of Sioux Tools, Inc.

## NO-MAR SHEET METAL FASTENERS

- No pliers or installation tools are necessary
- Maximum gripping strength due to unique tip design
- "No-Mar" plastic bodies are colour coded for easy identification



Part No.	Capacity	Drill Size	Colour	Fig
SSL 3/32	0 - 1/4"	#40	Red	A
SSL 1/8	0 - 1/4"	#30	Yellow	A
SSL 5/32	0 - 1/4"	#20	Blue	A
SSL 3/16	0 - 1/4"	#10	Black	A
SEL 3/32	0 - 1/2"	#40	Red	B
SEL 1/8	0 - 1/2"	#30	Yellow	B
SEL 5/32	0 - 1/2"	#20	Blue	B
SEL 3/16	0 - 1/2"	#10	Black	B
SEL 1/4	0 - 1/2"	1/4"	White	B

## MANUAL OPERATED TEMPORARY FASTENERS

- Easy to operate with wing nut for low production rate
- Manual controlled clamping force between 0-300lbs
- Metric range of wing nut version temporary fasteners available on application



Part No.	Cross Ref.	Grip Range	Drill Size	Colour
KWNS-FW-3/32	WNXS-SF-3/32	0 – 5/16"	#40	Zinc
KWNS-FW-1/8	WNXS-SF-1/8	0 – 5/16"	#30	Copper
KWNS-FW-5/32	WNXS-SF-5/32	0 – 5/16"	#20	Black
KWNS-FW-3/16	WNXS-SF-3/16	0 – 5/16"	#10	Brass
KWNS-FW-1/4	WNXS-SF-1/4	0 – 5/16"	F	Copper
KWN-FW-3/32	WNX-SF-3/32	0 – 1/2"	#40	Zinc
KWN-FW-1/8	WNX-SF-1/8	0 – 1/2"	#30	Copper
KWN-FW-5/32	WNX-SF-5/32	0 – 1/2"	#20	Black
KWN-FW-3/16	WNX-SF-3/16	0 – 1/2"	#10	Brass
KWN-FW-7/32	WNX-SF-7/32	0 – 1/2"	#2	Zinc
KWN-FW-1/4	WNX-SF-1/4	0 – 1/2"	F	Copper
KWN-FW-5/16	WNX-SF-5/16	0 – 1/2"	O	Black
KWNL-FW-3/32	WNXL-SF-3/32	0 – 1"	#40	Zinc
KWNL-FW-1/8	WNXL-SF-1/8	0 – 1"	#30	Copper
KWNL-FW-5/32	WNXL-SF-5/32	0 – 1"	#20	Black
KWNL-FW-3/16	WNXL-SF-3/16	0 – 1"	#10	Brass
KWNL-FW-7/32	WNXL-SF-7/32	0 – 1"	#2	Zinc
KWNL-FW-1/4	WNXL-SF-1/4	0 – 1"	F	Copper
KWNL-FW-5/16	WNXL-SF-5/16	0 – 1"	O	Black
KWNEL-FW-3/32	WNEXL-SF-3/32	1/2 – 1-1/2"	#40	Zinc
KWNEL-FW-1/8	WNEXL-SF-1/8	1/2 – 1-1/2"	#30	Copper
KWNEL-FW-5/32	WNEXL-SF-5/32	1/2 – 1-1/2"	#20	Black
KWNEL-FW-3/16	WNEXL-SF-3/16	1/2 – 1-1/2"	#10	Brass
KWNEL-FW7/32	WNEXL-SF-7/32	1/2 – 1-1/2"	#2	Zinc
KWNEL-FW-1/4	WNEXL-SF-1/4	1/2 – 1-1/2"	F	Copper
KWNEL-FW-5/16	WNEXL-SF-5/16	1/2 – 1-1/2"	O	Black
KWNK-FW-1/8	WNXK-SF-1/8	1-1/2 – 2-1/2"	#30	Copper
KWNK-FW-5/32	WNXK-SF-5/32	1-1/2 – 2-1/2"	#20	Black
KWNK-FW-3/16	WNXK-SF-3/16	1-1/2 – 2-1/2"	#10	Brass
KWNK-FW-7/32	WNXK-SF-7/32	1-1/2 – 2-1/2"	#2	Zinc
KWNK-FW-1/4	WNXK-SF-1/4	1-1/2 – 2-1/2"	F	Copper
KWNK-FW-5/16	WNXK-SF-5/16	1-1/2 – 2-1/2"	O	Black

## TEMPORARY FASTENER INSTALLATION/REMOVAL TOOL

Install and remove wing nut or hex nut temporary fasteners. Can be used with any power tool with at least 1/4" chuck or a 1/4" hex female spindle.



Part No.	Description	OAL
H92-302	Temporary Fastener Quick Tool	95mm

## NO-MAR CAPS – HEX BODY TEMPORARY FASTENER

Easily slips over Wing Nut or Hex Nut temporary fasteners to prevent damage to aircraft skin.



Part No.	Description	Size	Colour
KDCAP-3/32	No Mar Caps - Hex Body	3/32"	Grey
KDCAP-1/8	No Mar Caps - Hex Body	1/8"	Orange
KDCAP-5/32	No Mar Caps - Hex Body	5/32"	Black
KDCAP-3/16	No Mar Caps - Hex Body	3/16"	Blue
KDCAP-1/4	No Mar Caps - Hex Body	1/4"	Yellow

## CYLINDRICAL BODY TEMPORARY FASTENERS

The Cylindrical Body (CBX) series is designed to eliminate tedious fastener/tool orientation problems that can result in reduced installation and removal time. The double-lead thread design enhances overall installation and removal efficiency while its large bearing area makes it a suitable choice for both composite and metallic surfaces.



CBX-BF-5/16

Standard (CBX) 0-1/2" Grip			
Part No.	Diameter	Drill Size	Colour
CBX-BF-3/32	3/32	#40	Silver
CBX-BF-1/8	1/8	#30	Copper
CBX-BF-5/32	5/32	#20	Black
CBX-BF-3/16	3/16	#10	Brass
CBX-BF-7/32	7/32	7/32	Silver
CBX-BF-1/4	1/4	1/4	Copper
CBX-BF-5/16	5/16	5/16	Black

Extra Long (CBXEL) 1/2-1 1/2" Grip			
Part No.	Diameter	Drill Size	Colour
CBXEL-BF-3/32	3/32	#40	Silver
CBXEL-BF-1/8	1/8	#30	Copper
CBXEL-BF-5/32	5/32	#20	Black
CBXEL-BF-3/16	3/16	#10	Brass
CBXEL-BF-1/4	1/4	1/4	Copper
CBXEL-BF-5/16	5/16	5/16	Black

Long (CBXL) 0-1" Grip			
Part No.	Diameter	Drill Size	Colour
CBXL-BF-3/32	3/32	#40	Silver
CBXL-BF-1/8	1/8	#30	Copper
CBXL-BF-5/32	5/32	#20	Black
CBXL-BF-3/16	3/16	#10	Brass
CBXL-BF-7/32	7/32	7/32	Silver
CBXL-BF-1/4	1/4	1/4	Copper
CBXL-BF-5/16	5/16	5/16	Black

Super Long (CBXK) 1 1/2-2 1/2" Grip			
Part No.	Diameter	Drill Size	Colour
CBXK-BF-1/8	1/8	#30	Copper
CBXK-BF-5/32	5/32	#20	Black
CBXK-BF-3/16	3/16	#10	Brass
CBXK-BF-1/4	1/4	1/4	Copper
CBXK-BF-5/16	5/16	5/16	Black

## CYLINDRICAL TEMPORARY FASTENER RUNNER

- Suited for cylindrical Cleco fasteners 3/8" (CSX and CBX types)
- Pneumatic 1/8" BSP inlet



Part No.	RPM (no load)	Torque Nm	Torque in.lbs
SR-P1100-M3/8	1100	0.4 – 4.3	3.5 – 38.1
SR-P2300-M3/8	2300	0.4 - 2.1	3.5 - 18.6

## CYLINDRICAL CLECO INSTALLATION/REMOVAL TOOL

Installation and removal by flipping tool over



Part No.	Description
H92-310	Cylindrical Cleco Hand Tool

## CYLINDRICAL TEMPORARY FASTENER RUNNER

- E-Lit runner series Suited for cylindrical Cleco fasteners 3/8" (CSX and CBX types)



Part No.	RPM (no load)	Torque Nm	Torque in.lbs
ER-2.5-1550-P	500-1550	0.4-2.5	0.3-1.8
ER-6-1000-P	300-1000	0.8-6	0.6-4.4
ER-8-800-P	300-765	1.5-8	1.1-5.9
ER-12-600-P	250-570	3-12	2.2-8.8

## THUMBWHEEL CYLINDRICAL BODY FASTENER TOOL

Installation and removal by flipping tool over



Part No.	Description
H92-320	Thumbwheel Cylindrical Tool



## Composite & Metal Anti-Fatigue Solutions

Westcoast Industries (WCI) now represented in Australia by Henchman Products, pioneered cold expansion technology over 40 years ago and has advanced this science to develop innovative solutions for bushing installations, fastener applications and aerospace fitting and hardware installations. FTI products can improve aircraft structural durability and reduce manufacturing and maintenance flow-time and costs. Our products may be installed in both metal and composite applications. Torque ratings from 150-600 lb-in.

### FATIGUE LIFE ENHANCEMENT VIA COLDWORKING

Repeated stress due to cyclic loading can lead to failure in metal structures—especially at fastener and hole locations. While using thicker material may reduce fatigue, this carries the penalty of added weight and/or cost. In a one sided operation, coldworking involves pulling a tapered mandrel through a hole. The material preceding the major (largest) diameter is compressed into the surrounding hole (applied expansion). As the major diameter passes through the hole, the material behind the major diameter partially resumes its original configuration (retained expansion), thus creating a zone of residual compressive stress radially around the hole. This residual stress minimizes the effects of applied cyclic loading.

In addition to reducing the effect of cyclic loading; the zone of residual compressive stresses protects the hole from surface imperfections or material flaws. Coldworking is used extensively in new production, as well as rework of older structures, where it can retard the growth of undetected fatigue cracks.

Generally speaking, the fatigue life is extended several times.



### PROCESSES

Coldworking can be divided into two broad categories, the split sleeve and the sleeveless, split mandrel process. Developed in the early 1970's, the split sleeve process uses an internally lubricated, axially split, disposable, sleeve that lubricates the mandrel during the coldwork process. Somewhat newer, the split mandrel sleeveless process dispenses with the sleeve, and instead uses an automatically lubricated, longitudinally split, mandrel. This system is recognized as offering equal or superior fatigue life enhancement as compared to the split sleeve process, while accruing savings due to the elimination of the sleeve, as well as significantly improving worker productivity. This is used mainly in OEM production environments.

Split sleeve coldworking is available in three different categories, depending upon the application:

- **CB Process** – Used in aluminium and mild steel, with hole sizes ranging from 1/8" to 2 inches. The most widely used coldworking process, both for new .....production and rework applications.
- **CA Process** – For titanium and high-strength steels with a range from 1/8" to 45/64". Has a higher applied expansion than CB tooling, using high strength mandrels and cutting tools.
- **CR Process** – Special rework tooling for specific applications.

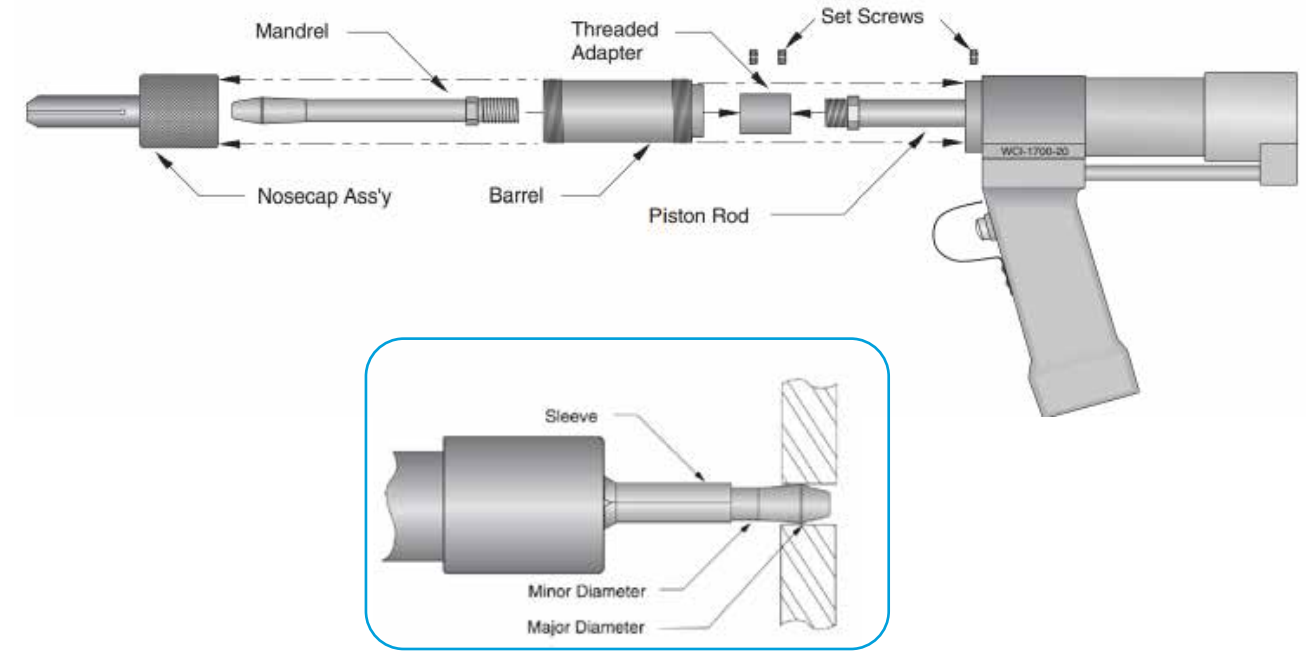

### SERVICE BULLETINS AND TOOLKITS

With the most complete line of coldwork tooling available in the world, WCI maintains an extensive inventory of tooling and replacement parts, allowing us to quickly respond to customer needs. WCI is a leader in providing commercial Service Bulletin Kits to the world's airlines and maintenance bases for specific rework applications. These kits are packaged with all the coldwork tooling, including cutting tools, needed to accomplish each specific service bulletin, all packaged in a rugged container. WCI's large inventory allows most kits to be couriered quickly from stock. In addition to specific service bulletin kits, WCI also provides a number of standard Coldwork Overhaul and Repair Kits (CWORK), containing capital and expendable tooling needed to coldwork a range of hole sizes.

Kits are contained in mobile cabinets for the utmost in versatility. Custom kits, based upon a customer's unique and specific requirements, are also available, as well as complete customer training. Maximum fatigue life enhancement begins with the highest quality tooling obtainable.

WCI is proud of its reputation as a quality leader in the industry, starting at the initial design phase and continuing through production and inspection

